



T&S BRASS AND BRONZE WORKS, INC.

2 Saddleback Cove / P.O. Box 1088
Travelers Rest, SC 29690



REG. #A2601
ISO #9001

Model No.

EC-3106-HG

Item No.

Travelers Rest, SC: 800-476-4103 Simi Valley, CA: 800-423-0150 Fax: 864-834-3518 www.tsbrass.com

This Space for Architect/Engineer Approval

Job Name _____ Date _____

Model Specified _____ Quantity _____

Customer/Wholesaler _____

Contractor _____

Architect/Engineer _____



ADA Compliant



Single Hole Deck Spout
w/ 2.2 GPM [8.3 L/min]
Vandal Resistant Aerator
and Manual Bypass Operation

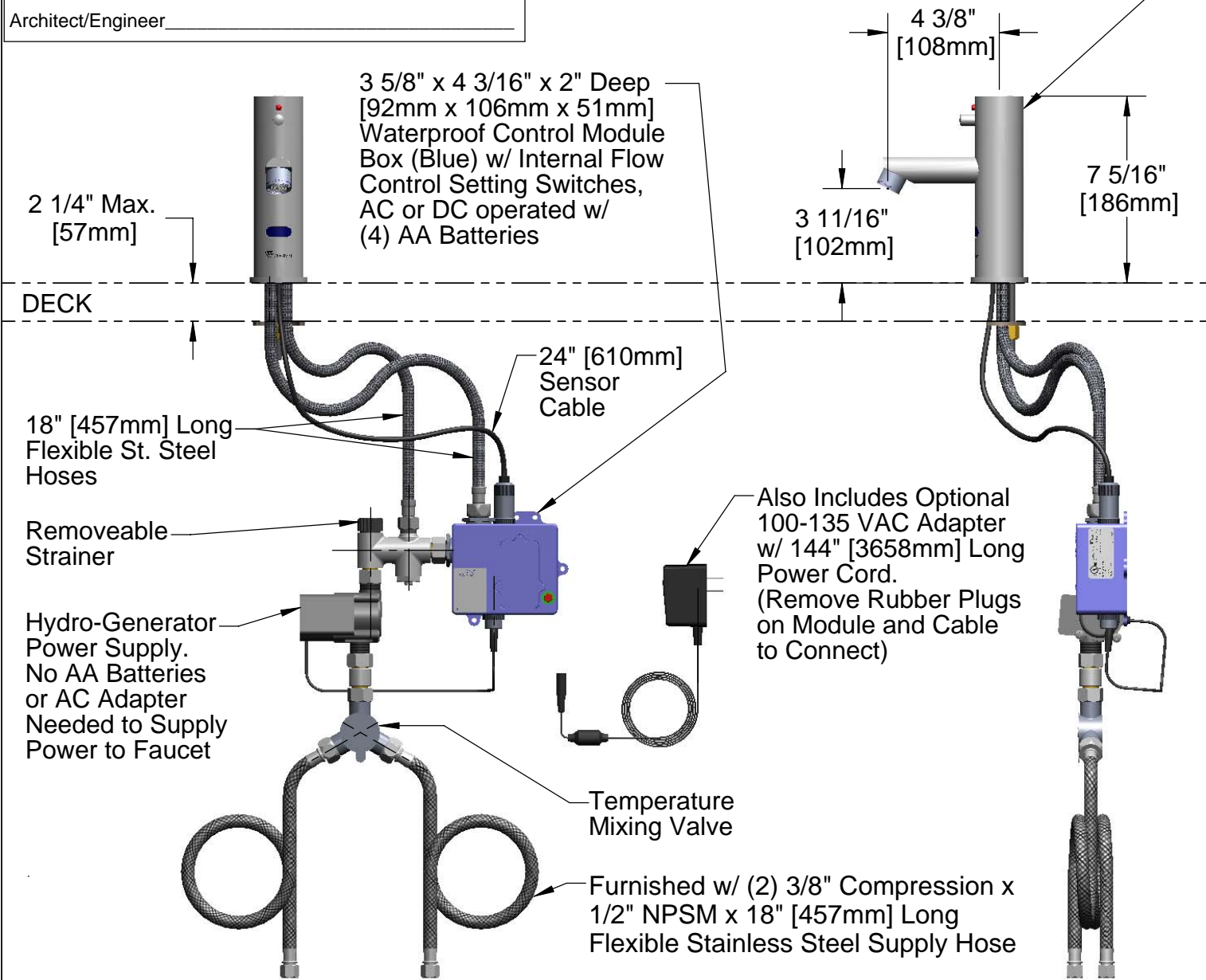

NOTE: Supply Stops by Others

Rough-in: ϕ 1 1/4" [32mm]

Product Specifications:

Chrome Plated Brass Electronic Faucet: Single Hole Deck Spout w/ VR Aerator & Manual Bypass, AC/DC Control Module w/ Internal Flow Control Setting Switches, Temperature Control Mixing Valve, Hydro-Generator, 18" Long Supply Stop Flexible Connector Hoses

Drawn DMH	Checked GEF	Approved JHB
Scale: NTS		Date: 06/02/09



T&S BRASS AND BRONZE WORKS, INC.

2 Saddleback Cove / P.O. Box 1088
Travelers Rest, SC 29690



REG. #A2601
ISO #9001

Model No.

EC-3106-HG

Item No.

Travelers Rest, SC: 800-476-4103 Simi Valley, CA: 800-423-0150 Fax: 864-834-3518 www.tsbrass.com

ITEM NO.	SALES NUMBER	DESCRIPTION
1	017493-45	ChekPoint Module (Blue) w/ Bypass Tee
2	EC-HYDROGEN	Hydro-Generator and Swivel Coupling
3	017506-45	1/2" NPSM Swivel Coupling
4	5EF-0006	Manual Mixing Valve
5	5EF-0005	Supply Hose, 9/16-24 Female X 1/2" NPSM
6	B-0199-09	VR Aerator w/ Key
7	Q015425-45	Vandal Resistant Key
8	5EF-0002	A/C Transformer
9	EC-FILTER	Replacement Filter

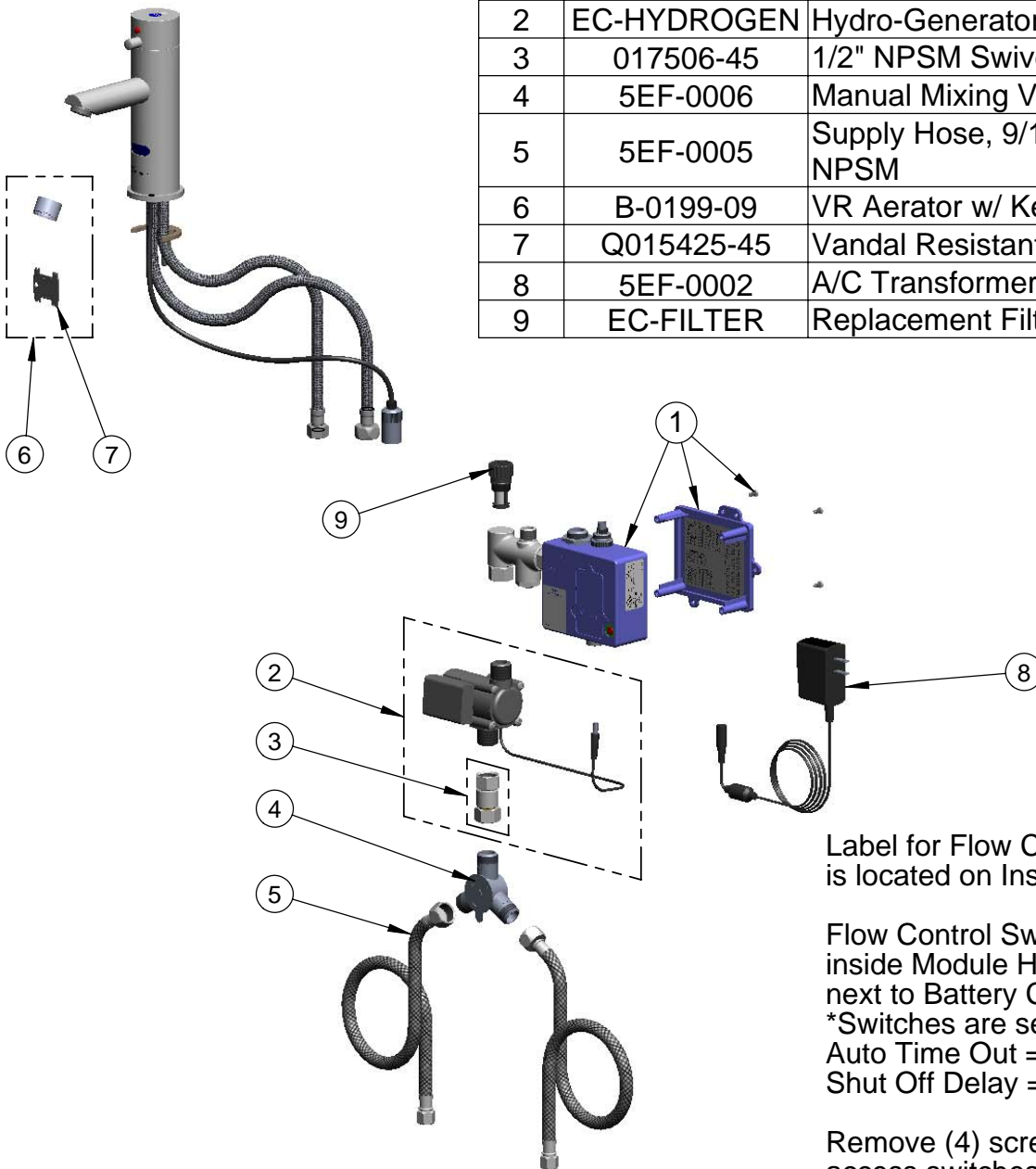

Label for Flow Control Switch Settings is located on Inside of Back Cover.

Flow Control Switches are located inside Module Housing in Black Box next to Battery Compartment.
*Switches are set to DEFAULT position:
Auto Time Out = 10 seconds
Shut Off Delay = 1 second.

Remove (4) screws and back cover to access switches.

***Available Water Flow Control Selections:**

- (6) Auto Time Out Selections - 10 sec, 25 sec, 45 sec, 60 sec, 3 min, 20 min
- (6) Shut Off Delay Selections - 1 sec, 2 sec, 3 sec, 4 sec, 5 sec, 6 sec

Product Specifications:

Chrome Plated Brass Electronic Faucet: Single Hole Deck Spout w/ VR Aerator & Manual Bypass, AC/DC Control Module w/ Internal Flow Control Setting Switches, Temperature Control Mixing Valve, Hydro-Generator, 18" Long Supply Stop Flexible Connector Hoses

Drawn	Checked	Approved
DMH	GEF	JHB
Scale:		Date:
NTS		06/02/09