



# T&S BRASS AND BRONZE WORKS, INC.

2 Saddleback Cove / P.O. Box 1088  
Travelers Rest, SC 29690



REG. #A2601  
ISO #9001

Model No.

**B-2465**

Item No.

Travelers Rest, SC: 800-476-4103 Simi Valley, CA: 800-423-0150 Fax: 864-834-3518 www.tsbrass.com

This Space for Architect/Engineer Approval

Job Name \_\_\_\_\_ Date \_\_\_\_\_

Model Specified \_\_\_\_\_ Quantity \_\_\_\_\_

Customer/Wholesaler \_\_\_\_\_

Contractor \_\_\_\_\_

Architect/Engineer \_\_\_\_\_



**ADA Compliant**

Support Rod Asm. Furnished w/  
Wall Bracket and Mounting Screws

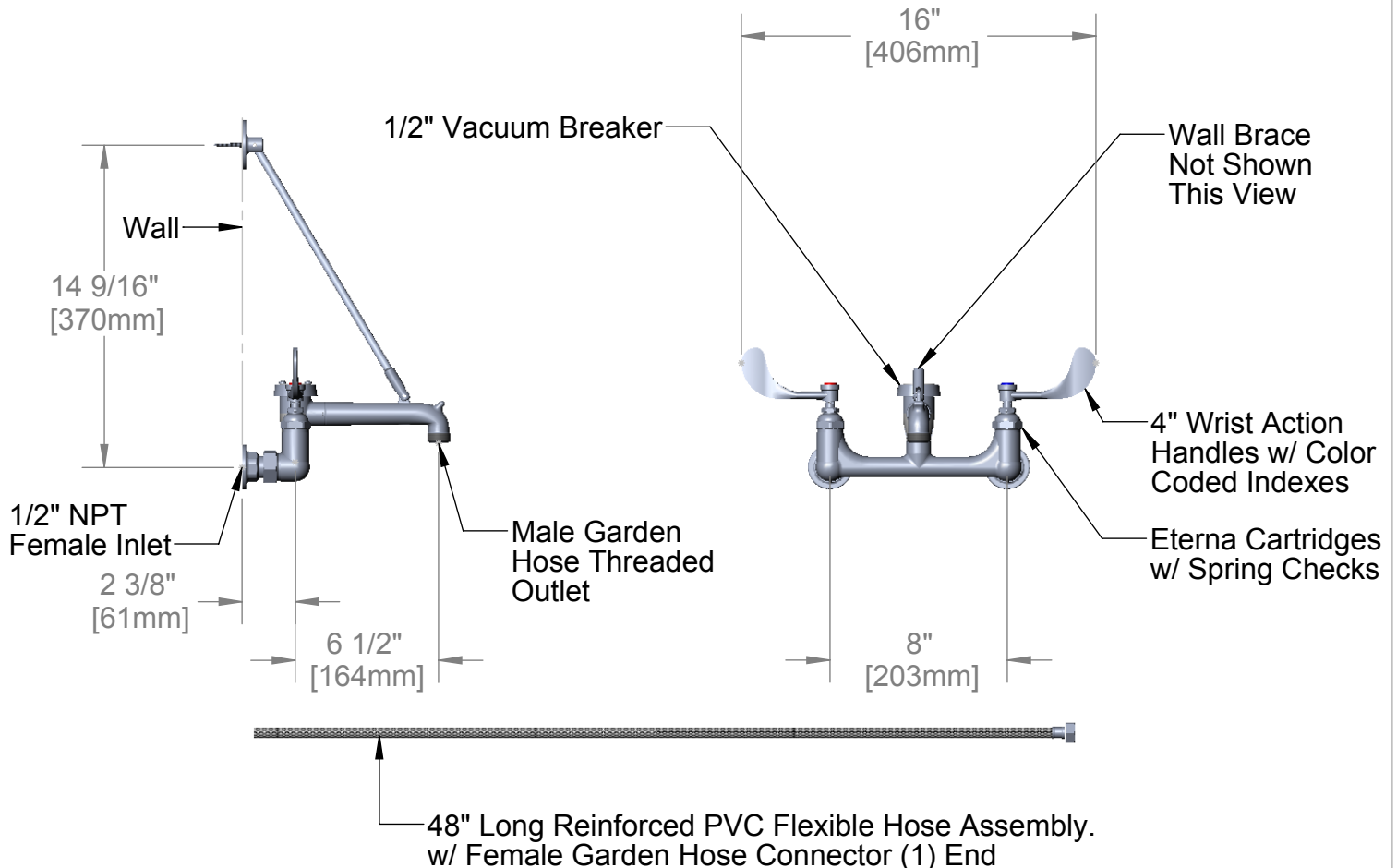
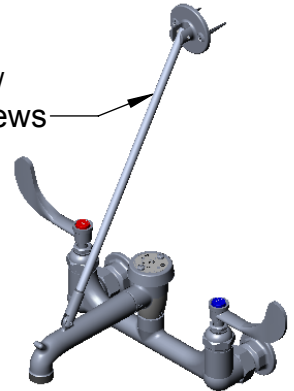

## Product Specifications:

Service Sink Faucet, 4" Wrist Action Handles, Vacuum Breaker Outlet, Integral Stops, Wall Brace Assembly & 1/2" NPT Inlets. (Furnished w/ 48" Long Reinforced PVC Hose Assembly)

Drawn  
KJG

Checked  
GEF

Approved  
JHB

Scale:

1:8

Date:

5/16/08

Sheet: 1 of 2



# T&S BRASS AND BRONZE WORKS, INC.

2 Saddleback Cove / P.O. Box 1088  
Travelers Rest, SC 29690



REG. #A2601  
ISO #9001

Model No.

**B-2465**

Item No.

Travelers Rest, SC: 800-476-4103 Simi Valley, CA: 800-423-0150 Fax: 864-834-3518 www.tsbrass.com

ITEM NO.	SALES NO.	DESCRIPTION
1	B-WH4	4" Wrist Action Handle
2	012443-40	Hot Eterna Spindle Assembly w/ Spring Check
3	012519-45	PVC Hose Asm, 48" Lg. Reinforced
4	B-0969	Vacuum Breaker, 1/2"
5	001194-45	Red HW Index
6	000925-45	Lab Handle Screw
7	001686-45	Blue CW Index
8	012442-40	Cold Eterna Spindle Assembly w/ Spring Check
9	00AA	Flange Assembly, 00AA
10	001019-45	Coupling Nut Washer

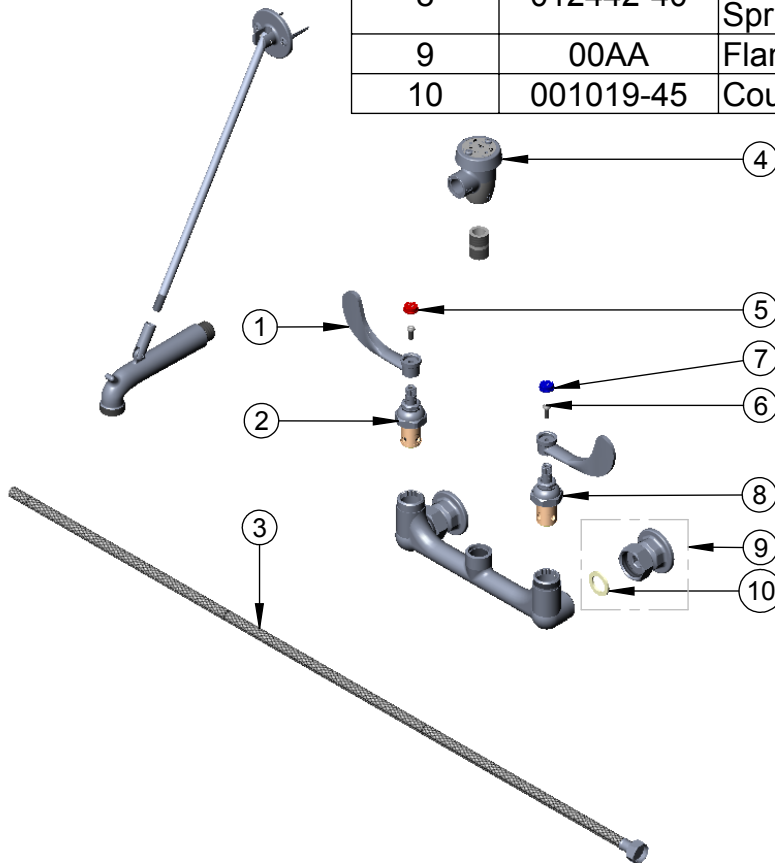

## Product Specifications:

Service Sink Faucet, 4" Wrist Action Handles, Vacuum Breaker Outlet, Integral Stops, Wall Brace Assembly & 1/2" NPT Inlets. (Furnished w/ 48" Long Reinforced PVC Hose Assembly)

Drawn

KJG

Checked

GEF

Approved

JHB

Scale:

1:8

Date:

5/16/08

Sheet: 2 of 2