



# T&S BRASS AND BRONZE WORKS, INC.

2 Saddleback Cove / P.O. Box 1088  
Travelers Rest, SC 29690



REG. #A2601  
ISO #9001

Model No.

**B-1431**

Item No.

Travelers Rest, SC: 800-476-4103 Simi Valley, CA: 800-423-0150 Fax: 864-834-3518 www.tsbrass.com

This Space for Architect/Engineer Approval

Job Name \_\_\_\_\_ Date \_\_\_\_\_

Model Specified \_\_\_\_\_ Quantity \_\_\_\_\_

Customer/Wholesaler \_\_\_\_\_

Contractor \_\_\_\_\_

Architect/Engineer \_\_\_\_\_

EPA2005 Non-Compliant

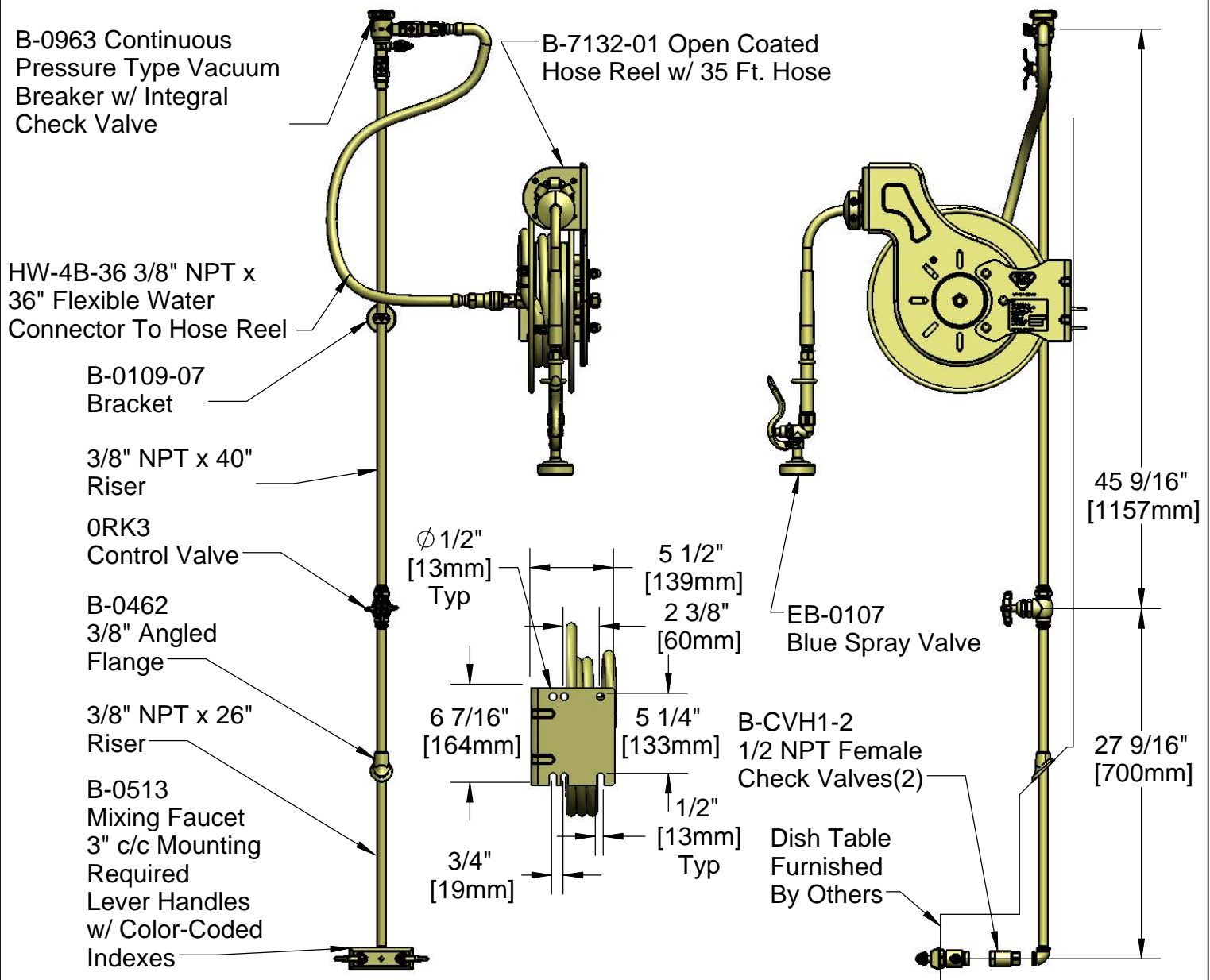

## Product Specifications:

Open Coated Hose Reel w/ 30 Ft Hose, Blue Spray Valve, Vacuum Breaker, 3/8" NPT Flex Water Connector Asm, 3" c/c Wall Mounted Faucet, & Control Valve In Riser

Drawn  
**JRM**

Checked  
**DMH**

Approved  
**JHB**

Scale:

**NTS**

Date:

**11/04/09**

Sheet: 1 of 2



# T&S BRASS AND BRONZE WORKS, INC.

2 Saddleback Cove / P.O. Box 1088  
Travelers Rest, SC 29690



REG. #A2601  
ISO #9001

Model No.

**B-1431**

Item No.

Travelers Rest, SC: 800-476-4103 Simi Valley, CA: 800-423-0150 Fax: 864-834-3518 www.tsbrass.com

ITEM NO.	SALES NO.	DESCRIPTION
1	B-0513	B-0513 Mixing Faucet
2	B-CVH1-2	1/2" Check Valve
3	000373-40	3/8" x 26" Nipple
4	0RK3	Valve Control
5	002558-40	3/8" NPT x 40" Riser
6	B-0109-07	Wall Bracket
7	B-0963	B-0963 VB
8	HW-2B-36	3/8 NPT x 36' Flex Water Hose
9	AW-5B	QD Water Socket/Plug 3/8" Brass
10	002535-25	3/8" Close Nipple
11	B-7132-01	Open Coated Reel 35' of 3/8" Hose
12	000907-45	Spray Valve Hold Down Ring
13	010476-45	#27 Washer
14	EB-0107	EB-0107 Spray Valve
15	B-0462	3/8" Angle Slip Flange
16	001355-40	Elbow, 3/8 NPT

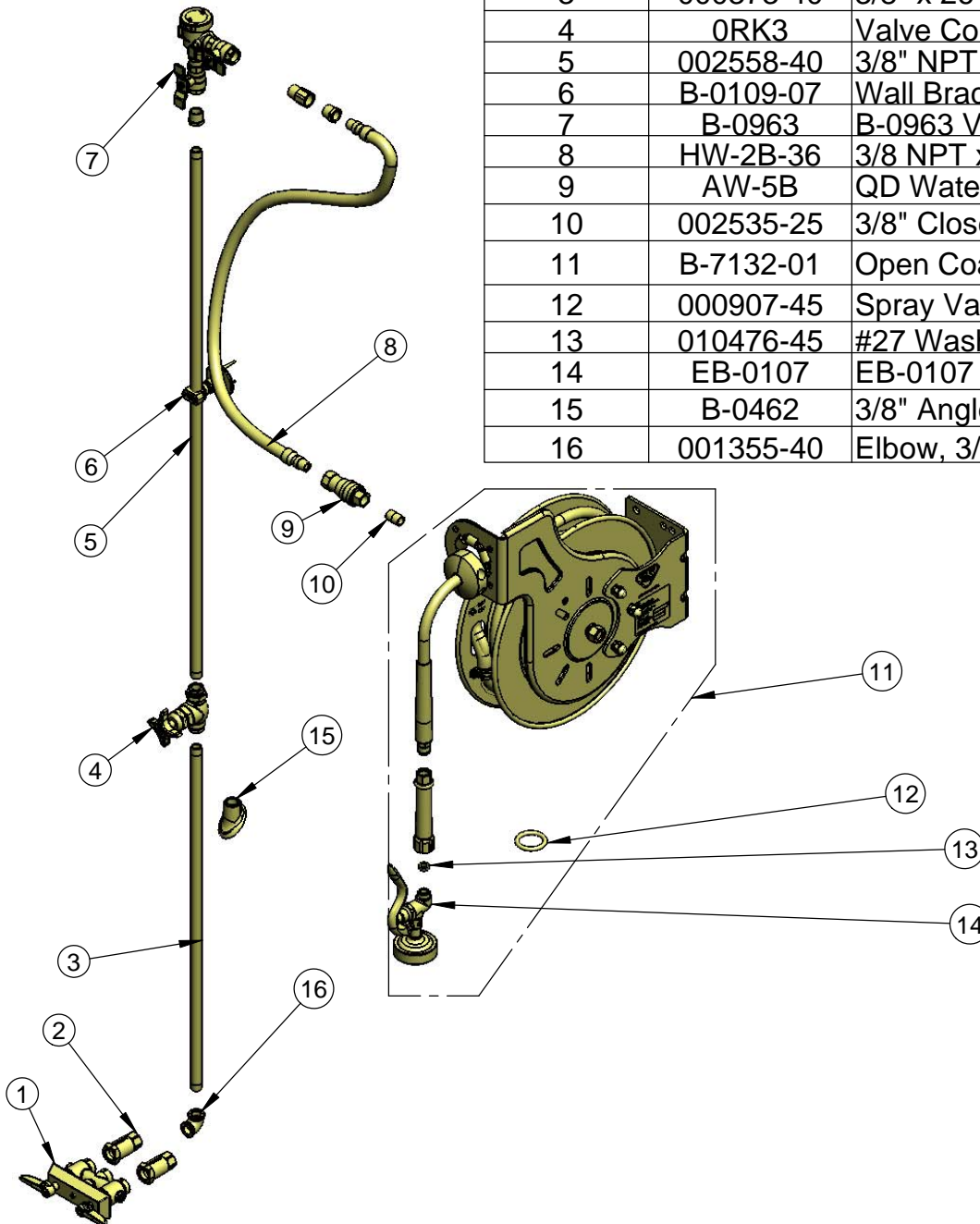

## Product Specifications:

Open Coated Hose Reel w/ 30 Ft Hose, Blue Spray Valve,  
Vacuum Breaker, 3/8" NPT Flex Water Connector Asm,  
3" c/c Wall Mounted Faucet, & Control Valve In Riser

Drawn

**JRM**

Checked

**DMH**

Approved

**JHB**

Scale:

**NTS**

Date:

**11/04/09**