

**T&S BRASS AND BRONZE WORKS, INC.**  
 2 SADDLEBACK COVE / P.O. BOX 1088 / TRAVELERS REST, SC 29690  
 PHONE 800-476-4103 - FAX 864- 834-3518



Model No.

B-1141-04

**RELIABILITY  
BUILT IN**

Job Name:

Architect/Engineer Approval:

Notes:

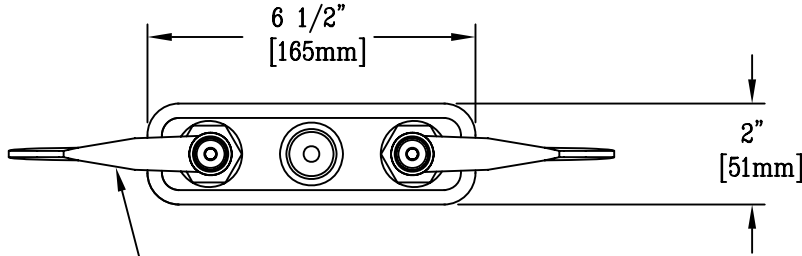

**TOP VIEW**

HOT & COLD INDEXED 4" BWH4 WRIST ACTION HANDLES



**ADA Compliant**

SWIVEL GOOSENECK w/ B-PT STREAM REGULATOR.

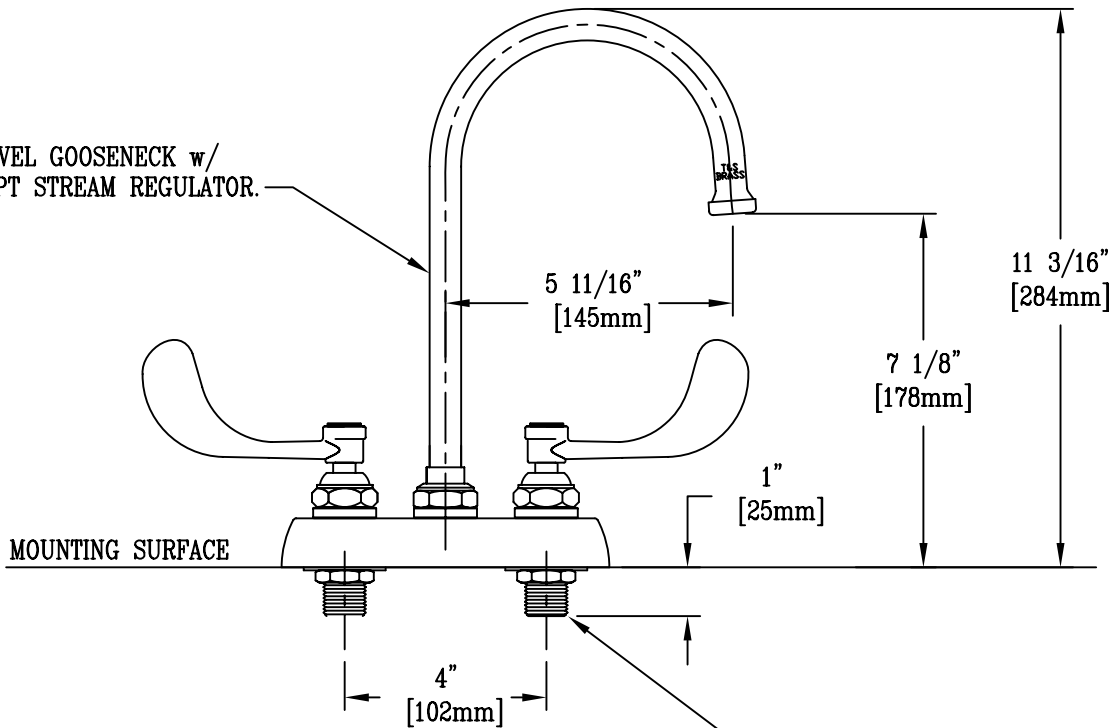

**FRONT VIEW**

1/2" NPT MALE SHANKS. (REQUIRES Ø1" CUTOUTS)

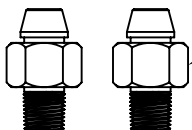

150A Tailpiece and Nut  
Furnished for 1/4" NPT  
Connection

Product Description:  
 WORKBOARD FAUCET w/ 1/2" NPT MALE SHANKS,  
 4" INLET CENTERS, 133X SWIVEL GOOSENECK,  
 & BWH4 WRIST ACTION HANDLES

Drawn:

KJG

Checked

JRM

Scale:

1 : 4

Approved

JHB

Date:

12/19/07