

PARTS BREAKDOWN

Haws 1431

NOTES:

1. CUT TUBING TO FIT AS REQUIRED.
2. CONNECT WHITE "POLYPROPYLENE" TUBING ON PRESSURE SIDE (INLET) OF VALVE.
3. CONNECT CLEAR "POLYETHYLENE" TUBING ON FREE FLOW SIDE (VALVE TO BUBBLER HEAD) ONLY.
4. REFER TO 7874/VRK5874 OPERATION AND MAINTENANCE MANUAL FOR INSTALLATION INSTRUCTIONS.
5. MUST APPLY 1 DOT OF LOCTITE 222MS THREADLOCKER ON FEMALE THREADS OF PUSH BUTTON ON FEMALE THREADS OF PUSH BUTTON. SEE 5874 OPERATION AND MAINTENANCE MANUAL (PAGE 5 OF 5) FOR PROPER APPLICATION PROCEDURE.

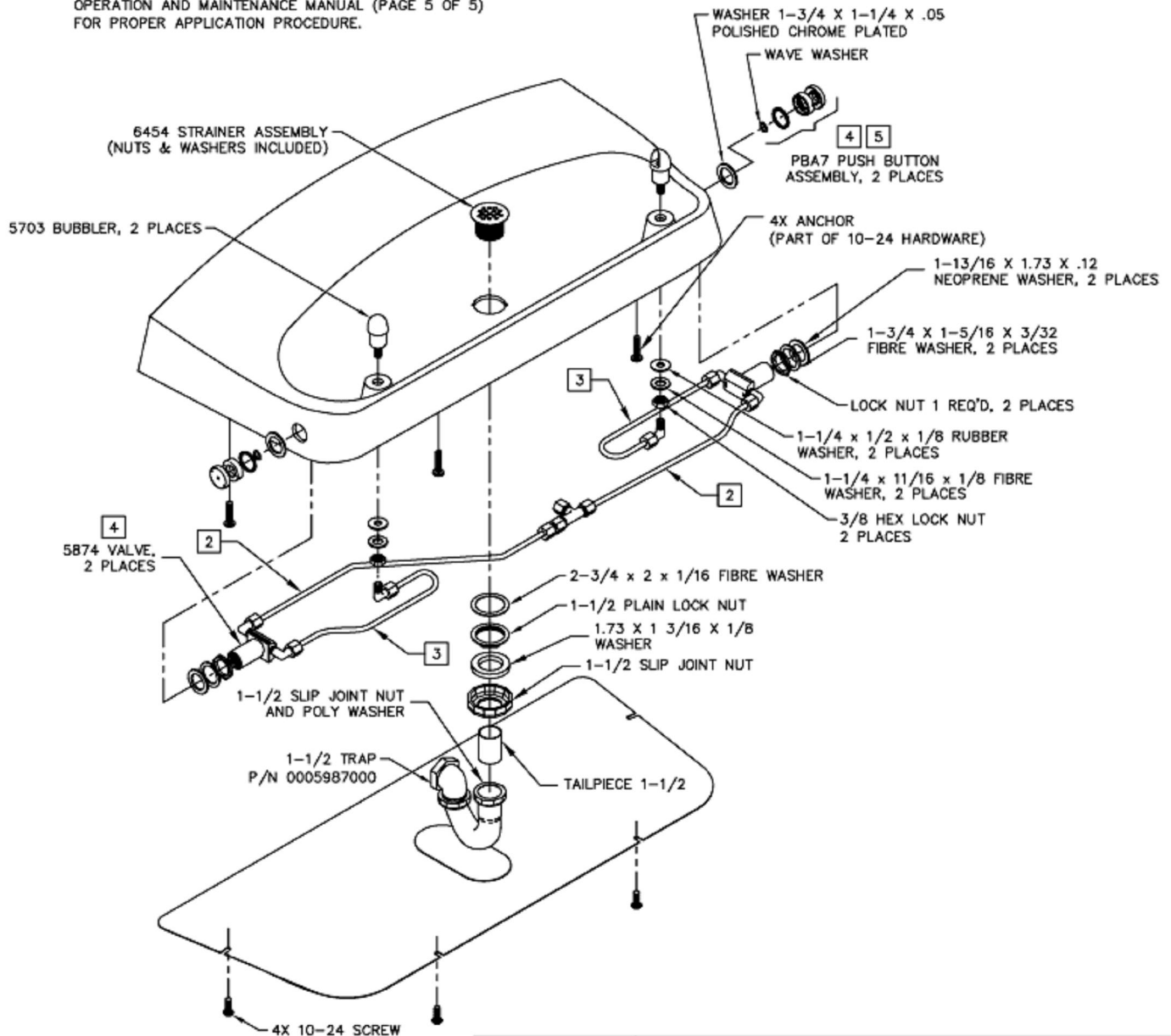

www.DrinkingFountainDoctor.com
1-800-518-5388