



**AQUARIUS**

*Kelvinator*

White-Westinghouse®

# ILLUSTRATED PARTS BREAKDOWN

**WATER COOLER MODELS:**  
**PLF8M-100    PLF14M-100**  
**PLF8MH-100    PLF14MH-100**  
**PSF8M-100**

## SPECIFICATIONS

### FOR MODELS PLF8M AND PLF8MH

Voltage	115 VAC ±10%/1PH/60 Hertz
Size (Approx)	26" H., 17" W., 13" D.
Shipping Weight (Approx)	77 LBS.
Cold Water Capacity	8 GPH
Compressor	1/5 HP
Compressor (Full Load)	5.0 Amps
Hot Tank	4.3 Amps
Refrigerant	134A
Refrigerant Charge	5-1/4 OZ. (148 GRAMS)

### FOR MODELS PLF14M AND PLF14MH

Voltage	115 VAC ±10%/1PH/60 Hertz
Size (Approx)	26" H., 17" W., 13" D.
Shipping Weight (Approx)	77 LBS.
Cold Water Capacity	14 GPH
Compressor	1/5 HP
Compressor (Full Load)	5.0 Amps
Hot Tank	4.3 Amps
Refrigerant	134A
Refrigerant Charge	5-1/4 OZ. (148 GRAMS)

\*A.R.I. Rating: Room Temperature 90°F; Supply Water Temperature 80°F; Drinking Water Temperature 50°F.

Specifications subject to change without notice.

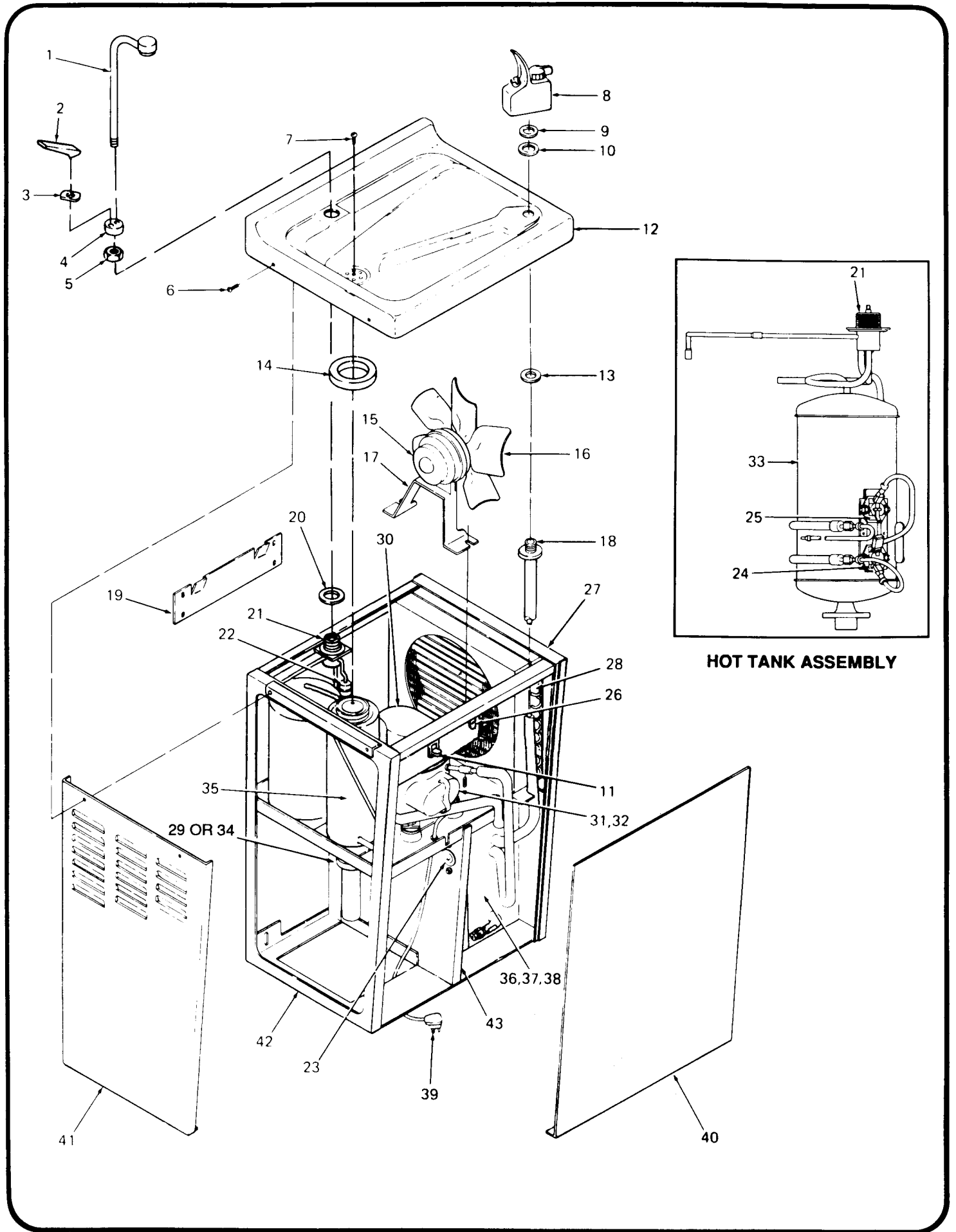

## PARTS LIST

ITEM NO.	DESCRIPTION	PLF8M PLF14M PSF8M	PLF8MH PLF14MH
1	Gooseneck .....	---	017590
2	Handle .....	---	017925
3	Tee Nut .....	---	017926
4	Cover .....	---	017927
5	Nut .....	---	017583
6	Top Screw .....	026630-005	026630-005
7	Drain Screw .....	026655-002	026655-002
8	12000A Valve Assembly .....	030774-002	030774-002
9	Valve Body Gasket .....	028706-006	028706-006
10	Friction Washer .....	028706-013	028706-013
11	Rocker Switch .....	---	029545-001
12	Top .....	028965-005	028965-002
13	Bubbler Spud Gasket .....	028706-001	028706-001
14	Waste Gasket .....	018050	018050
15	Fan Motor Assembly .....	027354-026	027354-026
16	Fan Blade .....	022977	022977
17	Fan Motor Bracket .....	018559	018559
18	Valve Spud .....	028701-002	028701-002
19	Hanger .....	016698-002	025662-001
20	Hot Valve Gasket .....	---	017582
21	Hot Valve Body and Stem Assembly .....	---	021516
22	Check Valve .....	---	019690
23	Cold Control .....	027040-007	027040-007
24	Hot Control w/Mounting Clip .....	---	028603-001
25	Heat Limiter w/Mounting Clip .....	---	028604-001
26	Panel Clip .....	018156-001	018156-001
27	Right Side Panel – Stainless Steel .....	018939R	018939R
	Right Side Panel – Sandstone .....	018937-004	018937-004
28	Condenser Assembly .....	024076-001	024076-001
29	Waste Assembly .....	019010-001	019010-002
30	Compressor (Includes 31 and 32) .....	031525-003	031525-003
31	Overload .....	031697-001	031697-001
32	Relay .....	031698-001	031698-001
33	Hot Tank .....	---	029359-001
34	Precooler Assembly .....	025198-001	031491-001
35	Precooler Insulation .....	018073-004	018073-004
36	Insulated Cooling Tank Assembly .....	028883-009	028974-009
37	Cooling Tank Insulation, RH .....	028660-001	028660-001
38	Cooling Tank Insulation, LH .....	028661-001	028661-001
39	Service Cord .....	026540-040	026540-040
40	Front Panel – Stainless Steel .....	019646	019646
	Front Panel – Sandstone .....	019644-002	019644-002
41	Left Side Panel – Stainless Steel .....	018939L	018939L
	Left Side Panel – Sandstone .....	018937-003	018937-003
42	Frame Assembly .....	028983-001	028983-001
43	Partition Plate .....	025148	025148
<b>NOT SHOWN</b>			
	Drier (Refrigerant) .....	031593-003	031593-003
	Glass Filler Installation Kit .....	031507-001	---
	Hole Cover .....	016994	---
	Selecto Filter (PSF8M only) .....	029681-002	---

# ELECTRICAL DIAGRAM

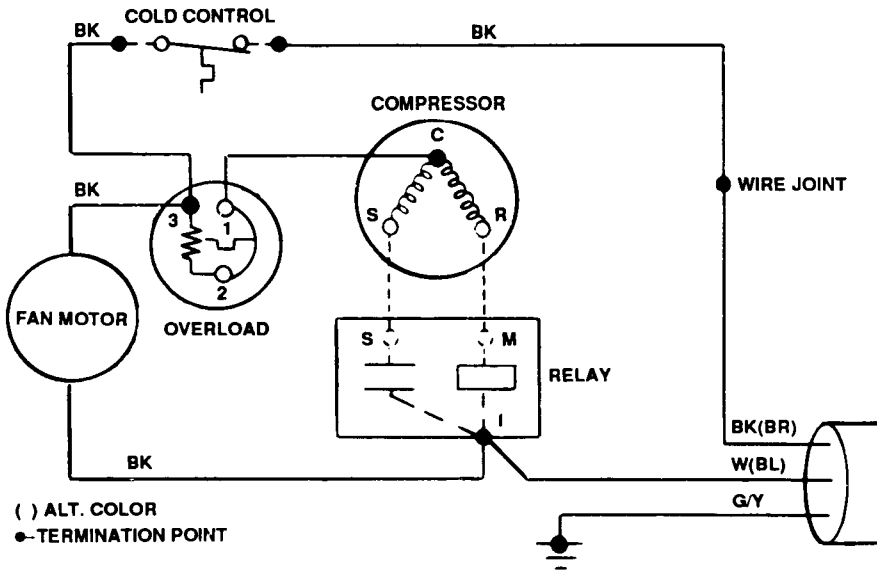

**PLF8M  
PLF14M  
PSF8M**

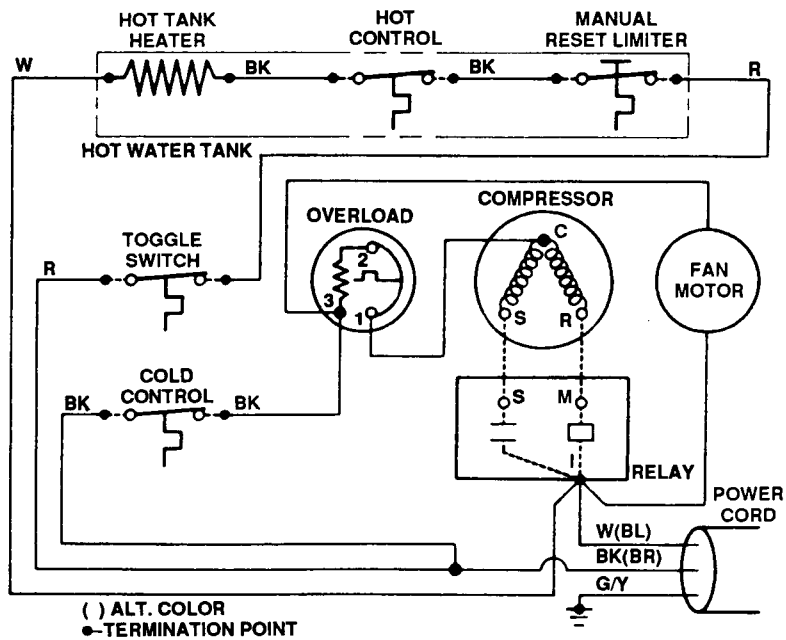

**PLF8MH  
PLF14MH**

OASIS® & AQUARIUS® are registered trademarks of EBCO Manufacturing Company  
The trademarks Kelvinator® and White-Westinghouse® are used under license from White Consolidated Industries, Inc.

**EBCO® MANUFACTURING COMPANY**

265 N. Hamilton Rd. • P.O. Box 13150 • Columbus, OH 43213-0150 • 614/861-1350 • Fax: 614/861-5017

Printed in U.S.A.  
Copyright 1994 EBCO Manufacturing Co.