

# SERVICE INSTRUCTIONS

...with Illustrated Parts Breakdown

# EBCO<sup>®</sup>

## Wheelchair Models DP7WM, DP7WM-D, DP7WM-P, DPWM, DPWM-D

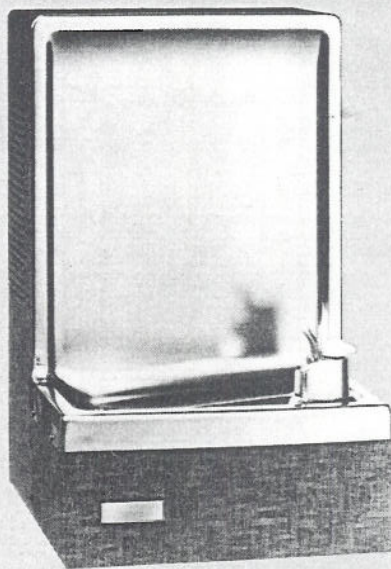

DP7WM and DPWM

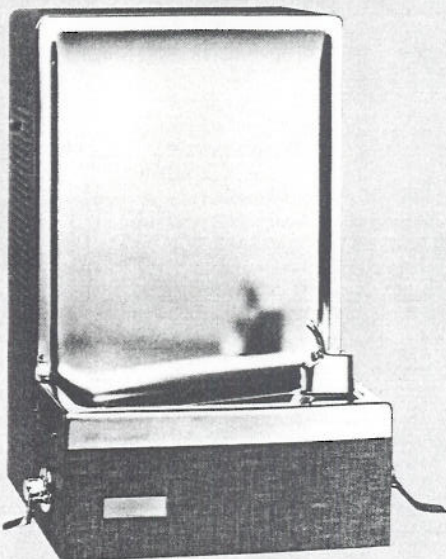

DP7WMD and DPWMD

## DESCRIPTION

Model DP7WM-D is uniquely designed to provide convenience and ease of operation to wheelchair and other handicapped users of the cooler.

There are "Soft-Touch" operating levers on either side of the cabinet, and the levers are activated to turn on the water with a very minimal pressure. Either "Soft-Touch" operating lever will activate the bubbler.

Model DP7WM-P has an electrically timed push button located on the center front cabinet. It can be activated with almost any part of the body.

Model DP7WM has the conventional single Dial-A-Drink bubbler operating lever.

Models DPWM and DPWM-D are not refrigerated.

All models have a metal plate which covers the entire bottom of the cabinet to protect against injury or torn clothing.

The refrigeration system is hermetically sealed at manufacture and is generally considered to be non-field serviceable. The air-cooled compressor pumps refrigerant through the fan-cooled condenser and capillary tube (expansion valve) to the cooling tank evaporator. The evaporator is wrapped around the cooling tank for high efficiency.

The electrical circuit includes automatic overload protection, and an adjustable cold control for water temperature regulation.

## SPECIFICATIONS

Voltage	115 VAC $\pm$ 10%/1PH/60 Hertz
Size	27-13/16" H., 18-1/2" W., 17-5/16" D.
Shipping Weight (Approx)	DP7WM and DP7WM-P - 82 LBS.
	DP7WM-D - 84 LBS.
	DPWM and DPWM-D - 45 LBS.
Cold Water Capacity*	7 GPH
Compressor	1/5 HP
Compressor (Full Load)	6.0 Amps
Refrigerant	R-500
Refrigerant Charge	4-1/8 OZ.
Compressor Oil Change (SUNISO 3G or equal)	10 OZ.

\*A.R.I. Rating: Room Temperature 90°F., Supply Water Temperature 80°F., Drinking Water Temperature 50°F.

Specifications subject to change without notice.

SWITCH FOR TIMER  
400101

SKINNER

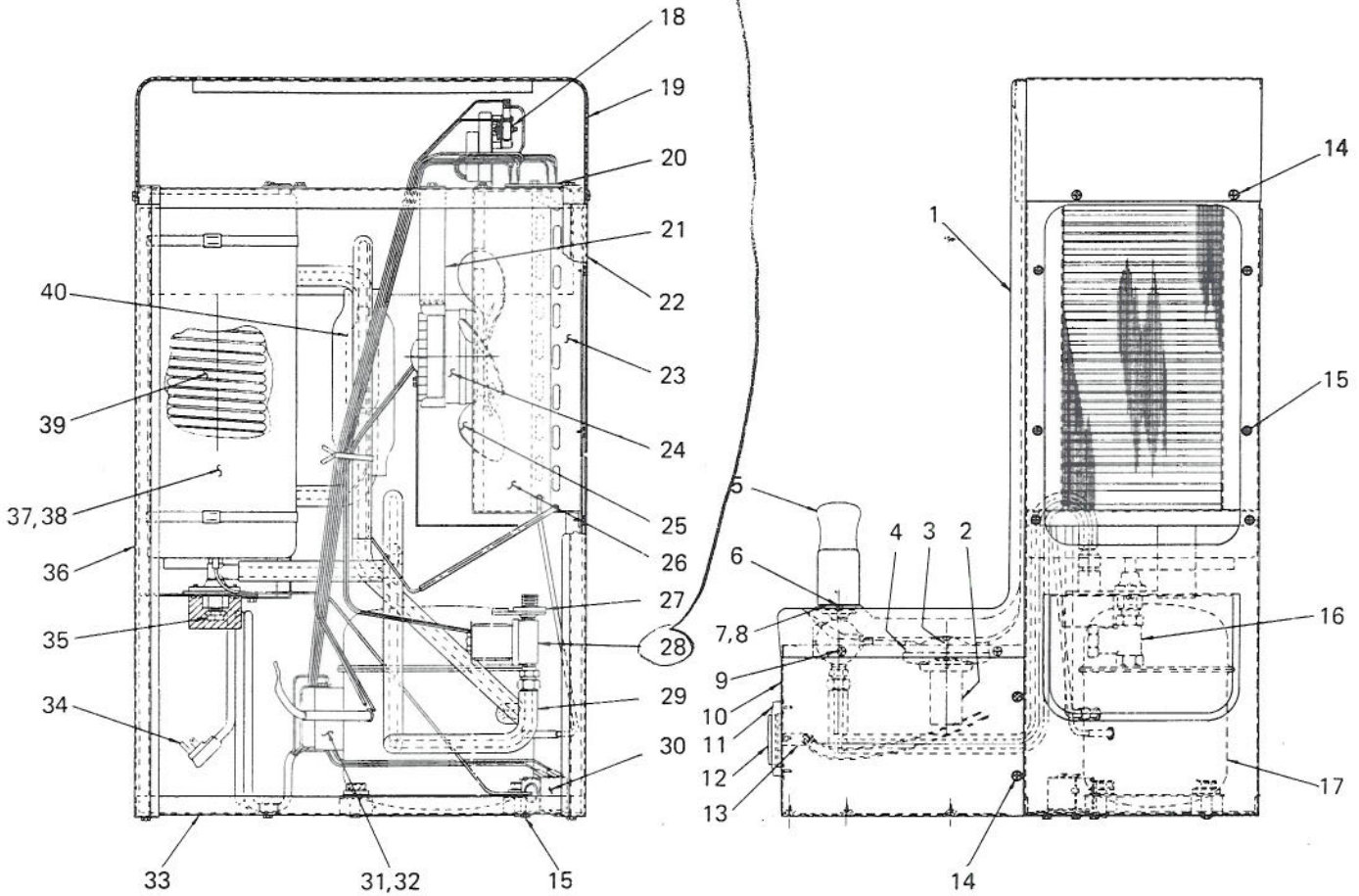

5/16 deep well

BEZEL RETAINER  
020203 (3 REQ.)

PRESSURE PAD  
025146

VALUE BODY  
025511

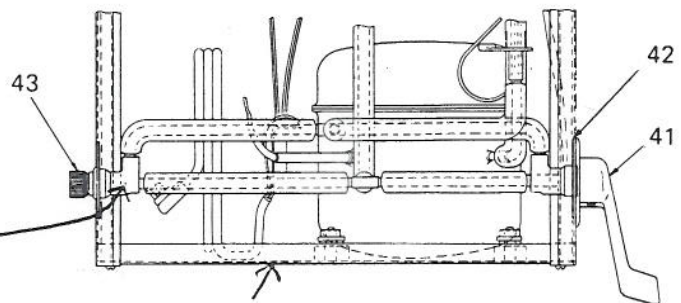

SUPPORT PLATE  
023391

# PARTS LIST

ITEM NO.	DESCRIPTION	DP7WM	DP7WM-D	DP7WM-P	DPWM	DPWM-D
1	Top	022323	022323	022323	022323	022323
	Top-Bronze	023245	023245	023245	023245	023245
2	Waste Assembly	023046	023046	023046	023046	023046
3	Waste Screw	026655-002	026655-002	026655-002	026655-002	026655-002
4	Waste Gasket	018050	018050	018050	018050	018050
5	Valve Assembly	026551-002	026551-006	026551-006	026551-002	026551-006
	Valve Assembly - Bronze	022607	023584	023584	022607	023584
6	Valve Spud Screw	026680-005	026680-005	026680-005	026680-005	026680-005
7	Valve Gasket	008983	008983	008983	008983	008983
8	Friction Washer	009281	009281	009281	009281	009281
9	Screw	026630-005	026630-005	026630-005	026630-005	026630-005
10	Wrapper - Painted (Specify Color)	022975-005	022975-019	022975-012	022975-005	022975-019
	Wrapper - Chestnut	022975-001	022975-015	022975-008	022975-001	022975-015
	Wrapper - Charcoal	022975-002	022975-016	022975-009	022975-002	022975-016
	Wrapper - Walnut	022975-003	022975-017	022975-010	022975-003	022975-017
	Wrapper - Stainless Steel	022975-006	022975-020	022975-013	022975-006	022975-020
	Wrapper - Bronze	022975-007	022975-021	022975-014	022975-007	022975-021
11	Bezel	---	---	024816	---	---
12	Push Button	---	---	024817	---	---
13	Switch	---	---	024764	---	---
14	Screw	026630-002	026630-002	026630-002	026630-002	026630-002
15	Screw	026642-003	026642-003	026642-003	026642-003	026642-003
16	Strainer Assembly	---	---	001800	---	---
17	Compressor (Includes Items 31 and 32)	017980	017980	017980	---	---
18	Timer Assembly	---	---	024937	---	---
19	Cap - Painted (Specify Color)	022976-005	022976-005	022976-005	022976-005	022976-005
	Cap - Chestnut	022976-001	022976-001	022976-001	022976-001	022976-001
	Cap - Charcoal	022976-002	022976-002	022976-002	022976-002	022976-002
	Cap - Walnut	022976-003	022976-003	022976-003	022976-003	022976-003
	Cap - Stainless Steel	022976-006	022976-006	022976-006	022976-006	022976-006
	Cap - Bronze	022976-007	022976-007	022976-007	022976-007	022976-007
20	Terminal Block	---	---	023265	---	---
21	Fan Motor Bracket	022946	022946	022946	---	---
22	Right Side Panel - Painted (Specify Color)	023038	023038	023038	023038	023038
	Right Side Panel - Chestnut	022979-001	022979-001	022979-001	022979-001	022979-001
	Right Side Panel - Charcoal	023032	023032	023032	023032	023032
	Right Side Panel - Walnut	023034	023034	023034	023034	023034
	Right Side Panel - Stainless Steel	023036	023036	023036	023036	023036
	Right Side Panel - Bronze	023251	023251	023251	023251	023251
23	Condenser	023135	023135	023135	---	---
24	Fan Motor	016490	016490	016490	---	---
25	Fan Blade	024033	024033	024033	---	---
26	Shroud	022972	022972	022972	---	---
27	Gasket (Under Top)	010545	010545	010545	010545	010545
28	Solenoid Valve - Stainless Steel	---	---	024121-801	---	---
	Solenoid Valve, Plastic	---	---	026313	---	---
29	Top Supply Line	023291	025512-001	023291	023291	025512
30	Cold Control	027040-001	027040-001	027040-001	---	---
31	Overload	017977	017977	017977	---	---
32	Relay	017978	017978	017978	---	---
33	Frame Assembly	022967	022967	022967	022967	022967
34	Service Cord	026540-004	026540-004	026540-004	---	---
35	Drain Plug	016899	016899	016899	---	---
36	Left Side Panel - Painted (Specify Color)	023037	023037	023037	023037	023037
	Left Side Panel - Chestnut	022980-001	022980-001	022980-001	022980-001	022980-001
	Left Side Panel - Charcoal	023031	023031	023031	023031	023031
	Left Side Panel - Walnut	023033	023033	023033	023033	023033
	Left Side Panel - Stainless Steel	023035	023035	023035	023035	023035
	Left Side Panel - Bronze	023252	023252	023252	023252	023252
37	Cooling Tank Insulation, L/H	022988	022988	022988	---	---
38	Cooling Tank Insulation, R/H	022989	022989	022989	---	---
39	Cooling Tank	023007	023007	025478	---	---
40	Heat Exchanger	023111	023111	023111	---	---
41	Handle Assembly	---	024927	---	---	024927
	Handle Assembly - Bronze	---	024928	---	---	024928
42	Handle Guide Plate	---	024922	---	---	024922
43	Stem Assembly	---	013059-001	---	---	013059
*	Hanger	025662-003	025662-003	025662-003	025662-003	025662-003

\* Not Shown

025512-001

# SERVICE CHECK CHART

TROUBLE	PROBABLE CAUSE	REMEDY
Unit not running	No electrical power	Check power source
	Defective cold control Defective relay	Check that cold control is not in off position Replace Replace
Unit running but not cooling	Refrigerant leak or low refrigerant	Add refrigerant
Unit running continuously	Defective cold control Low refrigerant	Replace Add refrigerant

## ELECTRICAL DIAGRAM

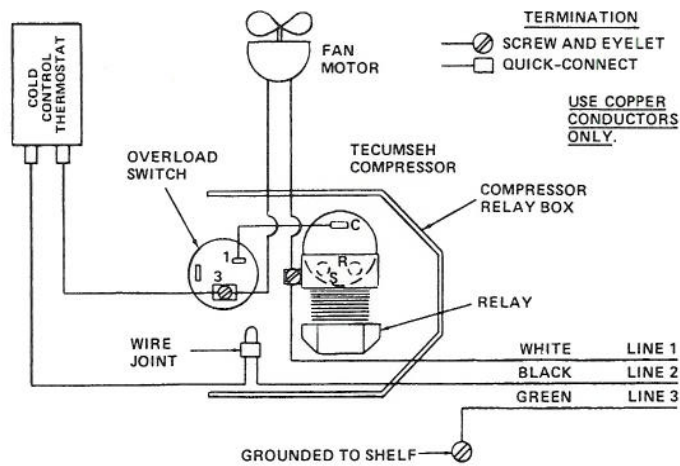
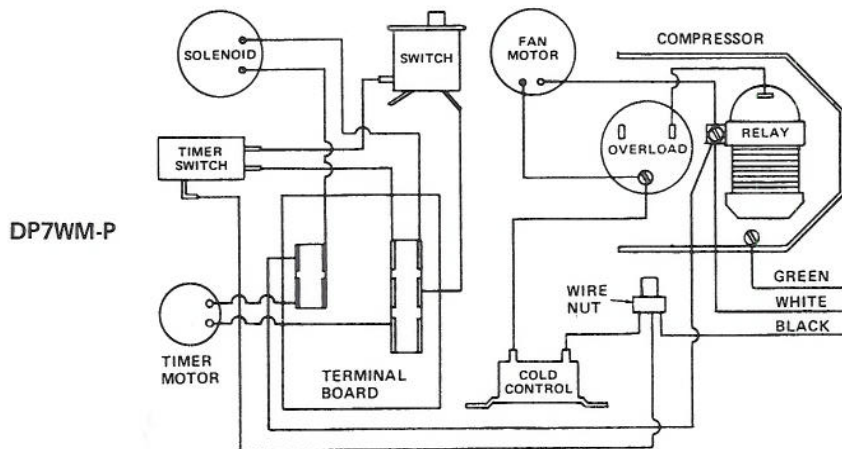

**EBCO<sup>®</sup> MANUFACTURING COMPANY**

265 N. Hamilton Rd. • P.O. Box 13150 • Columbus, OH 43213-0150 • 614/861-1350 • Cable: EBCO • Telex: 246637