

**HOW TO REPAIR GLASS FILLER FITTINGS  
313, 709 AND 709 HR  
WITH 386LDP-X UNIT LESS DASHPOT**

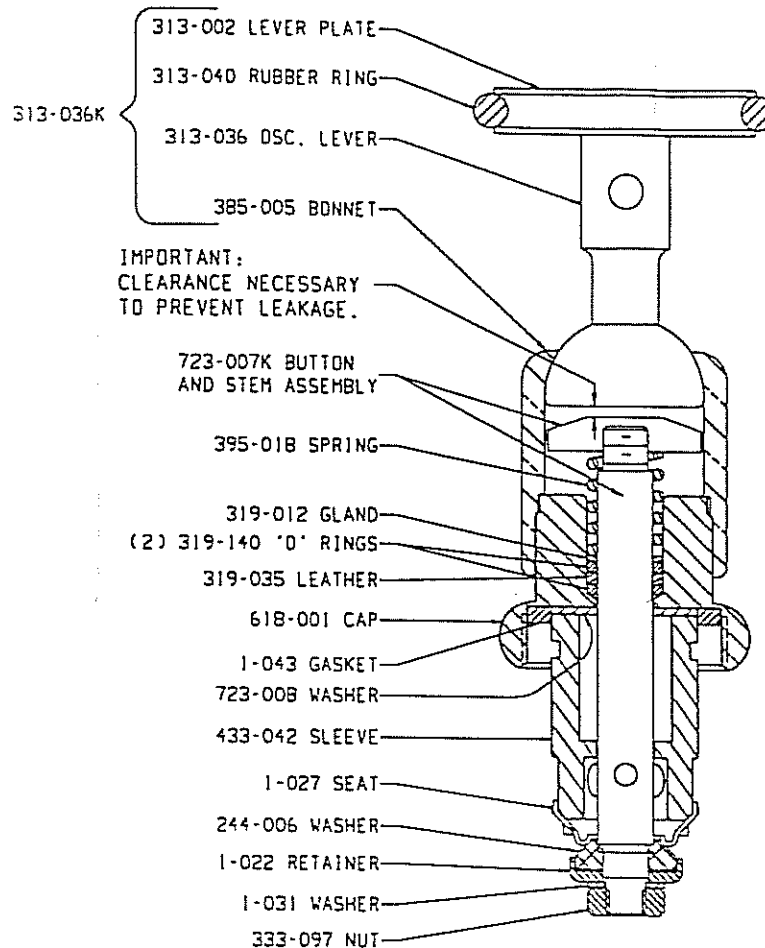

1. LOOSEN BONNET (386-005) ON 386LPD-X UNIT. THE ENTIRE OSCILLATING LEVER ASSEMBLY (313-036K) CAN THEN BE REMOVED BY LOOSENING THE BONNET BY HAND.
2. REMOVE UNIT FROM THE BODY BY LOOSENING CAP (618-001) WITH A FLAT FACE WRENCH.
3. IF LEAKAGE IS OCCURRING THROUGH SPOUT OUTLET, INSERT 1/8" DIAMETER PIN OR PIN WRENCH (244-025) THROUGH HOLE IN STEM AND WITH QUARN WRENCH REMOVE STEM NUT (333-097) AND ALL PARTS UP TO AND INCLUDING (1-027) SEAT. INSPECT SEAT WASHER (244-006) AND REPLACE IF NECESSARY. NEXT, INSPECT SEAT (1-027) FOR NICKS OR WATER CUTTING AND REPLACE IF NECESSARY.

4. IF UNIT HAS BEEN LEAKING BETWEEN OSCILLATING LEVER AND UPPER CAP, LIFT OUT STEM ASSEMBLY (723-007K) AND SPRING (395-018) FROM SLEEVE (433-042) AND CAP (618-001) BY TAKING OUT WASHER (319-012). FROM CAP TAKE OUT PACKING ARRANGEMENT WHICH CONSISTS OF (2) O-RINGS (319-140) WITH (1) LEATHER (319-035) BETWEEN O-RINGS. GREASE STEM LIGHTLY AROUND PACKING AREA AND PUT NEW O-RINGS AND PACKING ON STEM USING SAME ARRANGEMENT AS INDICATED. ALSO LUBRICATE O.D. OF PACKINGS.
5. PLACE STEM WITH SPRING, WASHER AND PACKINGS PROPERLY ASSEMBLED BACK INTO CAP AND SLEEVE. NOW ASSEMBLY LOWER UNIT PARTS IN PROPER RELATION AND INSERT PIN OR PIN WRENCH (244-025) IN STEM HOLE AGAIN AND TIGHTEN NUT (333-097).
6. WE RECOMMEND REMOVING AND REPLACING 1-043 GASKET BEFORE UNIT IS PLACED IN VALVE BODY. PLACE UNIT IN BODY AND LOCK UNIT BY TIGHTENING CAP (618-001) SECURELY. ADD UPPER CAP AND OSCILLATING LEVER SUB-ASSEMBLY TO UNIT.