



T&S BRASS AND BRONZE WORKS, INC.
 2 Saddleback Cove / P.O. Box 1088
 Travelers Rest, SC 29690



REG. #A2601
 ISO #9001

Model No.
B-2465

Item No.

Travelers Rest, SC: 800-476-4103 Simi Valley, CA: 800-423-0150 Fax: 864-834-3518 www.tsbrass.com

ITEM NO.	SALES NO.	DESCRIPTION
1	B-WH4	4" Wrist Action Handle
2	012443-40	Hot Eterna Spindle Assembly w/ Spring Check
3	012519-45	PVC Hose Asm, 48" Lg. Reinforced
4	B-0969	Vacuum Breaker, 1/2"
5	001194-45	Red HW Index
6	000925-45	Lab Handle Screw
7	001686-45	Blue CW Index
8	012442-40	Cold Eterna Spindle Assembly w/ Spring Check
9	00AA	Flange Assembly, 00AA
10	001019-45	Coupling Nut Washer

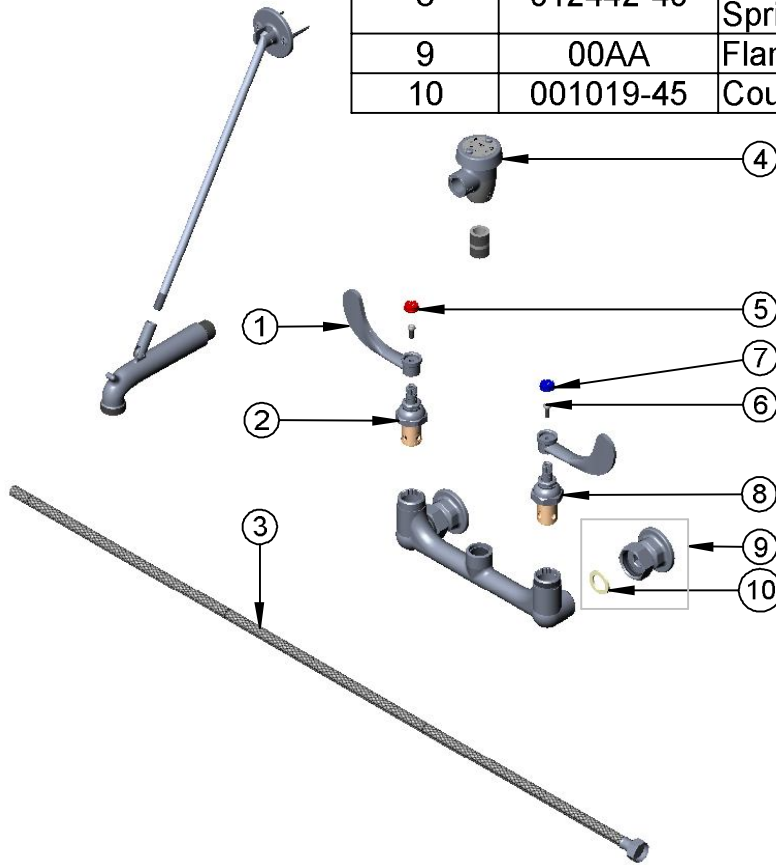

Product Specifications:

Service Sink Faucet, 4" Wrist Action Handles, Vacuum Breaker Outlet, Integral Stops, Wall Brace Assembly & 1/2" NPT Inlets. (Furnished w/ 48" Long Reinforced PVC Hose Assembly)

Drawn KJG	Checked GEF	Approved JHB
Scale: 1:8		Date: 5/16/08