



ADJUSTABLE OPERATING ROD

Prevents Faucet Tube From Bursting in Freezing Conditions!

(Fits Woodford Models 14, 16, 17, 19, 22 or V22)

INCLUDES ANTI-BURST PRV VALVE

- Upgrade a Woodford Model 14 or 17 wall faucet or replace a Model 16, 19 or 22 operating rod with an RK-ADJ-PRV Adjustable Length Operating Rod with patented, resetting Pressure Relief Valve (PRV).
- The PRV is designed to prevent the copper tube from bursting in freezing conditions *even if a hose is unintentionally left on.*

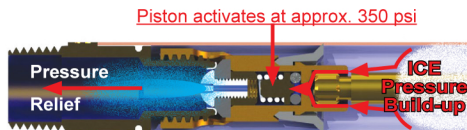

- Arrange and assemble a combination of color coded rod stems to provide a replacement rod from 4" to 14" Woodford model lengths in 2" increments.
- Sample installation instructions are shown below. *Complete full scale instructions are provided with each RK-ADJ-PRV.*

RK-ADJ-PRV Components

NOT SOLD SEPERATLEY

- (1) Inlet Stem
- (1) Middle Stem
- (1) Handle Stem
- (1) Stem Stop
- (2) Stainless Steel Clips
- (1) EPDM Packing
- (1) Packing Nut
- (1) Round Metal Wheel Handle
- (1) Handle Screw

2 Clips

Instructions Video



youtube.com/wcmind

See Reverse Side For More Faucet Accesories

Installation Instructions



- 1
- Shut off water supply
 - Remove Handle Screw, Handle, Packing Nut and Packing.
 - Use flat head screwdriver to remove packing material.

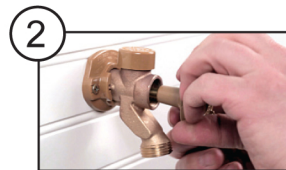

- 2
- Place handle back on rod without screw and turn counter-clockwise.
 - Remove old rod.
 - Save and reuse old brass washer

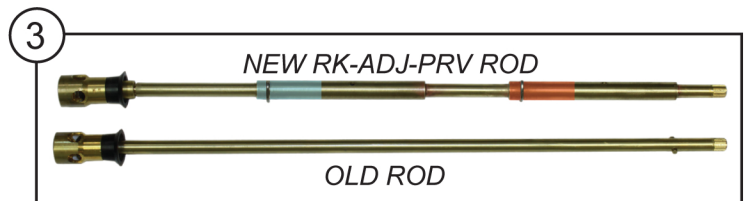

- 3
- Match old rod length with the new RK-ADJ-PRV rod assembly combination using chart below.

Assembly Combinations According To Measured Operating Rod Overall Length

6" Overall Length

8" Overall Length

10" Overall Length

12" Overall Length

14" Overall Length

16" Overall Length

Note: Lengths are not to scale. A detailed, full scale, diagram is included with each RK-ADJ-PRV.

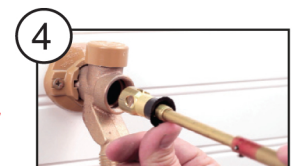

- 4
- Insert new RK-ADJ-PRV
 - Assemble old brass washer, new Packing, Packing Nut, Handle and Handle Screw.
 - Turn on water.