

CHICAGO FAUCETS

a Geberit company



2100 SOUTH CLEARWATER DRIVE
DES PLAINES, ILLINOIS 60018-5999

FITTING NO.

9913

SUBMITTED MODEL NO.

JOB NAME

ITEM NO.

SUBMITTED AS SHOWN

SUBMITTED AS NOTED

SEE ATTACHED FOR
SUBMITTED MODIFICATION

NOTE: RECOMMENDED MOUNTING HOLE FOR
BURETTE 1-1/8"-1-3/16" [28mm-30mm] DIA.

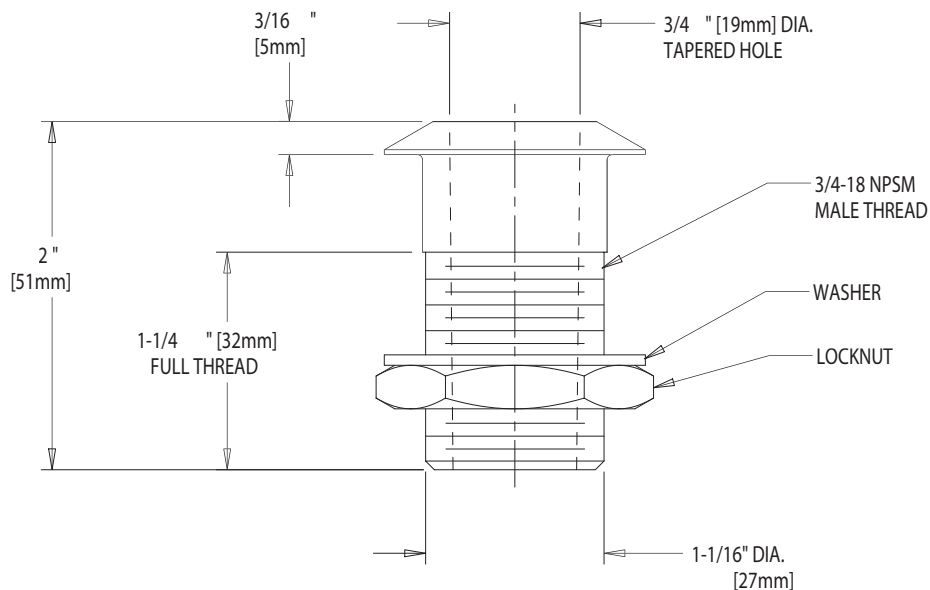
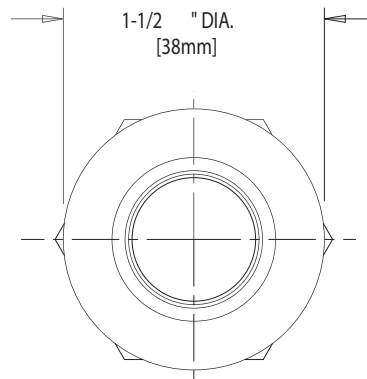

DIMENSIONS IN INCHES AND [MILLIMETERS].

TECHNICAL DATA

- ALUMINUM BURETTE SOCKET, COUNTERTOP

DATE: 2-7-03

BY: JAR

CHK'D:

APP'D:

REV: A

9913

IS ASSUMED FOR USE OF SUPERCEDED OR VOIDED DATA.

ROUGHING IN DIMENSIONS MAY VARY AND ARE SUBJECT TO CHANGE. NO RESPONSIBILITY