



T&S BRASS AND BRONZE WORKS, INC.

2 Saddleback Cove / P.O. Box 1088
Travelers Rest, SC 29690



REG. #A2601
ISO #9001

Model No.
BL-6000-02

Item No.

Travelers Rest, SC: 800-476-4103 Simi Valley, CA: 800-423-0150 Fax: 864-834-3518 www.tsbrass.com

This Space for Architect/Engineer Approval

Job Name _____ Date _____

Model Specified _____ Quantity _____

Customer/Wholesaler _____

Contractor _____

Architect/Engineer _____

Note :

For Pressures Above 0.5 PSIG
or Oxygen and Specialty Gases,
Use BL-4010-01 Gas Cock

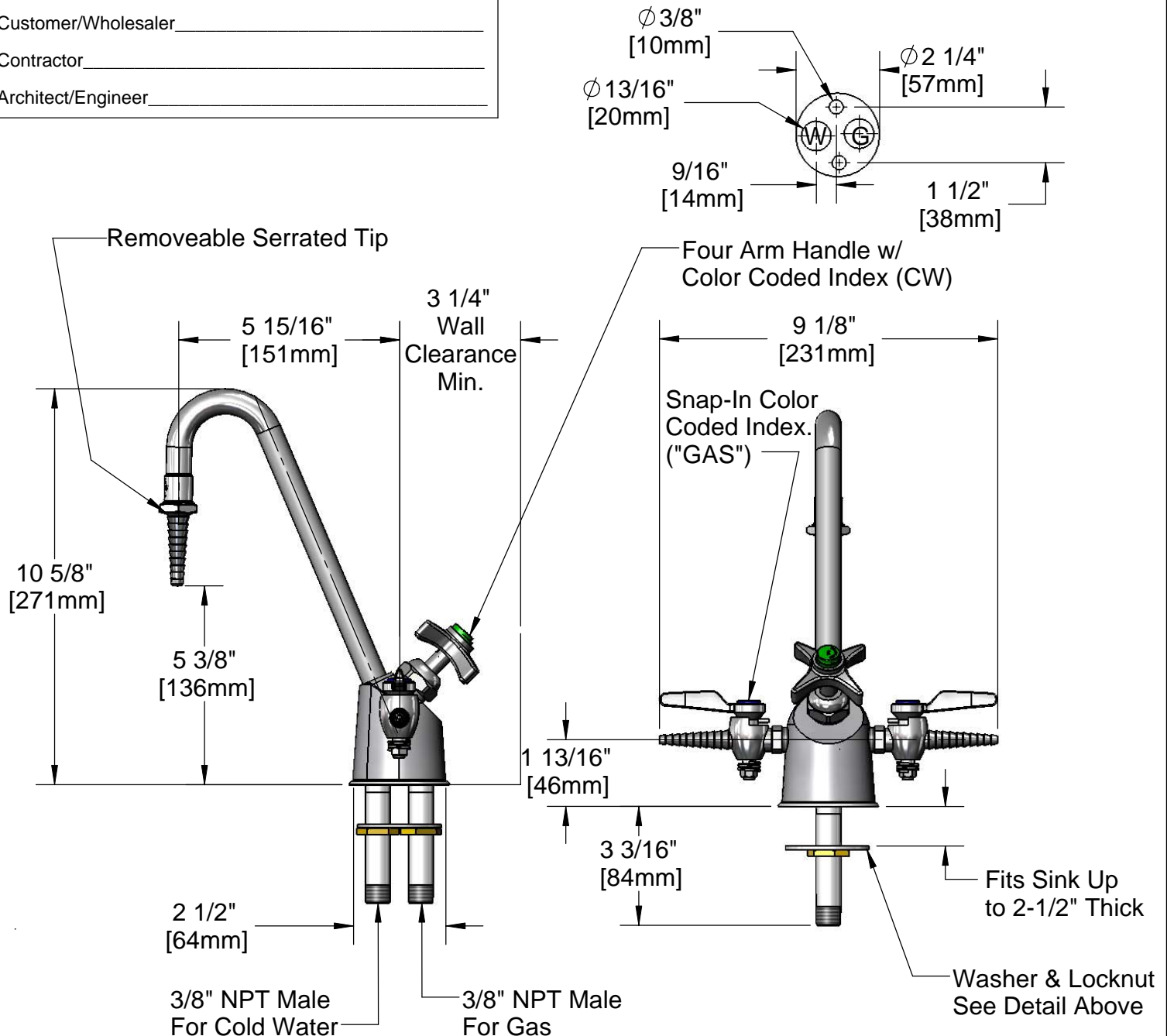

Product Specifications:

Combination Gas & Water Fixture w/
2 Gas Cocks, Gooseneck w/
Serrated Tip, 3/8\" NPT Inlets

Drawn
ARH

Checked
DHL

Approved
JHB

Scale:

1:4

Date:

06/11/09



T&S BRASS AND BRONZE WORKS, INC.

2 Saddleback Cove / P.O. Box 1088
Travelers Rest, SC 29690



REG. #A2601
ISO #9001

Model No.

BL-6000-02

Item No.

Travelers Rest, SC: 800-476-4103 Simi Valley, CA: 800-423-0150 Fax: 864-834-3518 www.tsbrass.com

ITEM NO.	SALES NO.	DESCRIPTION
1	000392-40	Gooseneck, 3/8", Rigid, Brass
2	001051-45	Washer, 7/8" OD X 11/16 ID X 3/32 Thick
3	B-0198	Serrated Tip & Washer
4	000381-20	Nipple, Supply, 3/8" Pipe, Brass
5	000969-45	Nut, Lock, 3/8" NPSL, Brass
6	001004-45	Washer, Turret BL-6000, Brass
7	001160-45	Gasket, BL-6000
8	BL-4000-01	Hose Cock, Ground Key, 0.5 PSIG
9	001197-45	Cap, Index, Blue, Gas
10	001191-45	Cap, Index, Green, Cold Water

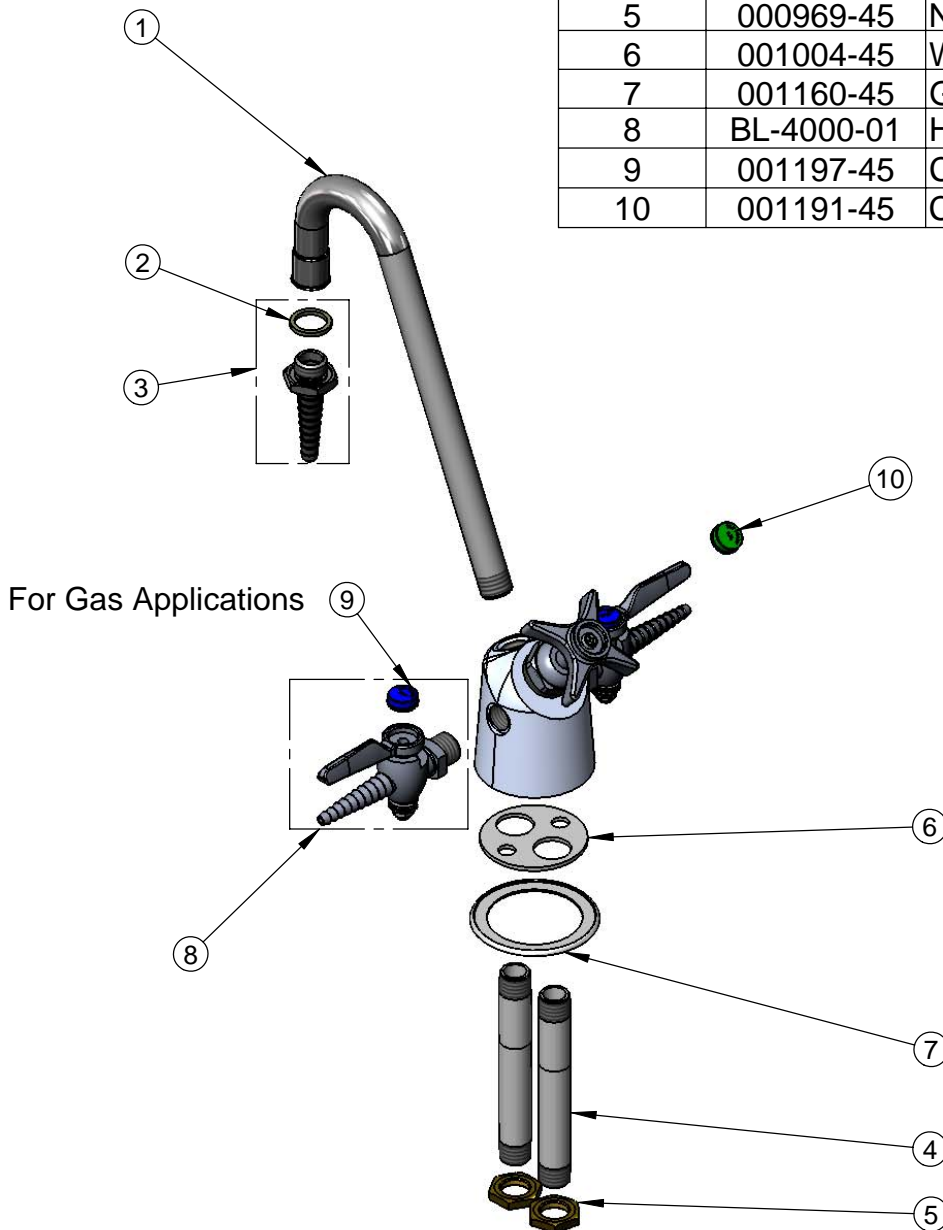

Product Specifications:

Combination Gas & Water Fixture w/
2 Gas Cocks, Gooseneck w/
Serrated Tip, 3/8" NPT Inlets

Drawn
ARH

Checked
DHL

Approved
JHB

Scale:

1:4

Date:

06/11/09