

Replacement Parts for Stainless Steel Reel Rinse Units

Replacement parts for the following Models:
#29602 - SS Exp RR 50' Hose Spray Valve
#29610 - SS Exp RR 35' Hose Spray Valve
#29645 - SS Cvrdd RR 50' Hose Spray Valve
#29653 - SS Cvrdd RR 35' Hose Spray Valve

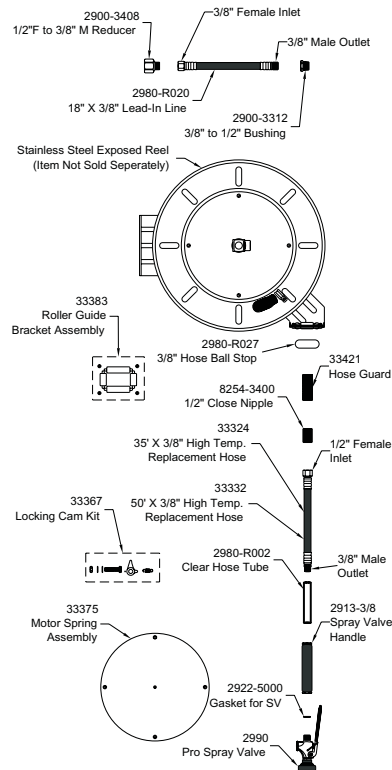

Replacement Parts for the following Models:
#29626 - SS Exp RR 50' Hose Spray Gun
#29599 - SS Exp RR 35' Hose Spray Gun
#29629 - SS Cvrdd RR 50' Hose Spray Gun
#29637 - SS Cvrdd RR 35' Hose Spray Gun

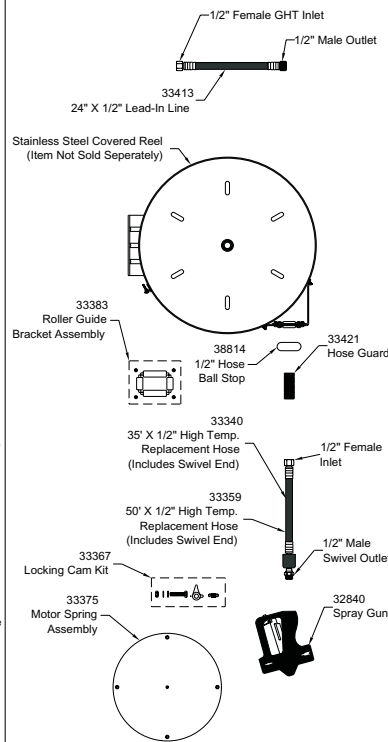

PART NO. 33685

FISHER
 MANUFACTURING COMPANY
 PO BOX 60, TULARE, CA 93275
 (800)421-6162, FAX: (800)832-8238
 www.fisher-mfg.com

REV. C

FISHER
 FISHER MANUFACTURING COMPANY

Stainless Steel Reel Rinse Units Products Manual

Since 1936, Fisher Manufacturing Company has manufactured heavy-duty, high quality plumbing products and hardware specialties for the food service industry. For three generations, the Fisher family has adhered to a strict dedication of and overall value. When you install Fisher products... you install the best. Our hardware is manufactured with the standardization of internal mechanisms. All chrome plating is triple plated copper, nickel and chrome for durability. Every piece of equipment we make is rigorously tested in both our modern in-house testing center and in actual field situations under extreme conditions. Every detail is thoroughly checked. Before we make our products available to you, they pass each and every test. You get proven performance. Guaranteed.

Limited One Year Warranty

Fisher Manufacturing Company warrants its products and parts thereof (except as noted below) against defects in materials or workmanship for a period of one year after the date of original purchase. During this period Fisher Manufacturing Company will replace a defective product or part without charge to you, provided that the entire product is delivered to Fisher Manufacturing Company. All transportation and insurance charges for shipping the product to and from Fisher Manufacturing Company must be borne by you. Charges for transportation and insurance may, at the option of Fisher Manufacturing Company, be refunded depending upon our investigation of the warranty claim. This warranty does not cover external finish (except at date of original purchase) or labor costs not specifically authorized by Fisher Manufacturing Company.

A full and complete copy of our One Year limited warranty is available upon request.

WARNING:

Proposition 65 requires that we provide you with the following notice: "This product Contains A Chemical Known To The State Of California To Cause Birth Defects Or Other Reproductive Harm."



#29262 - Stainless Steel Exposed Reel Rinse Unit with 50' of 1/2" ID Black Rubber Hose and Spray Gun

#29599 - Stainless Steel Exposed Reel Rinse Unit with 35' of 1/2" ID Black Rubber Hose and Spray Gun

#29602 - Stainless Steel Exposed Reel Rinse Unit with 50' of 3/8" ID Black Rubber Hose and Spray Valve

#29610 - Stainless Steel Exposed Reel Rinse Unit with 35' of 3/8" ID Black Rubber Hose and Spray Valve

#29629 - Stainless Steel Covered Reel Rinse Unit with 50' of 1/2" ID Black Rubber Hose and Spray Gun

#29637 - Stainless Steel Covered Reel Rinse Unit with 35' of 1/2" ID Black Rubber Hose and Spray Gun

#29645 - Stainless Steel Covered Reel Rinse Unit with 50' of 3/8" ID Black Rubber Hose and Spray Valve

#29653 - Stainless Steel Covered Reel Rinse Unit with 35' of 3/8" ID Black Rubber Hose and Spray Valve

KEEP THIS MANUAL FOR FUTURE REFERENCE



ANSI/A112.18.1M, ANSI/NSF 61.9

FISHER MANUFACTURING COMPANY - TOLL FREE: 800-421-6162 FAX: 800-832-8238

www.fisher-mfg.com

Installation Instructions for Reel Rinse Units

WARNING: Failure to read, understand and follow these instructions may result in Hazards or unsafe practices which COULD result in severe personal injury or death.

BE SURE TO CHECK WITH YOUR LOCAL DEPARTMENT HAVING JURISDICTION REGARDING BACKFLOW PREVENTION.

Installation Notes:

- It is highly recommended that at least 2 people are involved in this installation as the hose reel is very heavy.
- Be sure water supply is shut-off before beginning.
- It is recommended that any installation kit or control box is completely installed before proceeding with hose reel installation.
- It is highly recommended that all mounting configuration adjustments be performed BEFORE mounting reel.

Items needed for Installation

- 4 - 5/16" Mounting Bolts or Lag Bolts (not included)
- 4 - Lock and Flat Washers for Bolts (not included)
- 1 - Ratchet Socket Set (not included)
- 1 - Crescent wrench (not included)

Mounting Configuration Adjustment

The hose reel assembly is provided in a wall mount configuration. If a different mounting configuration is required, such as ceiling or deck mounting, do the following:

For exposed reels 29599, 29262, 29610, 29602

1. Unscrew and remove the 4 arm nuts located near the center of the reel (figure 1).

Note: DO NOT remove the larger center nut.

- 2a. Remove the hose arm from the bolts.
- 3a. Move bolts into desired position and replace hose arm.
- 4a. Screw nuts tightly back onto the bolts.

For Covered reels 29637, 29629, 29653, 29645

- 1b. Loosen the 2 sleeve nuts located toward the mounting plate.

Note: DO NOT remove the sleeve.

- 2b. With the 2 sleeve nuts loose, rotate the sleeve about the reel to desired position.
- 3b. Tighten nuts back onto the sleeve screws.

Secondary Support Chain

DANGER: A secondary safety cable or chain is to be attached to all reels mounted overhead to prevent reel from falling. Immediate hazards WILL result in severe personal injury or death.

All hose reels mounted overhead should have a secondary support chain or steel cable to protect personnel in case of structure or mounting component failure. The support chain or cable should be rated for no less than a 300 lb load.

Attach one end of secondary support chain or cable to reel. Attach other end of secondary support chain or cable to a support component other than that which supports the reel. The chain or cable should be as short as possible allowing the reel to drop no more than 6 to 12 inches if the primary connection is released.



Figure 1, Exposed Hose Reel

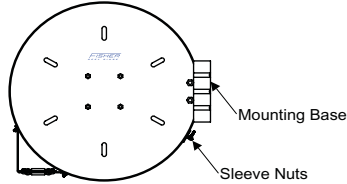

Figure 2, Covered Hose Reel

Installation Instructions Continued

General Mounting Requirements:

- Main shaft must be horizontal
- When mounted overhead add a secondary chain or cable to prevent reel from falling in case of mounting failure.
- For wall and ceiling mounting, be sure the roller guide is horizontal to the floor.
- See Figures 3 and 4 for proper hose reel orientation:



Figure 3, Correct and Incorrect Wall Mounting



Figure 4, Correct and Incorrect Ceiling Mounting

Mounting the Hose Reel

1. Unpack reel and remove from wooden base.
2. Adjust, if necessary, arm or sleeve to the required mounting configuration. (see Mounting Configuration Adjustment section)
3. Using the hole pattern in Figure 5, mark and drill appropriate pilot holes into mounting surface.
4. Mount complete hose reel onto wall by securing and tightening all bolts and nuts.
5. If mounted over-head, install secondary safety cable or chain (see secondary support chain section).
6. Connect the lead-in line to the hose reel inlet located on the left-hand side of the hose reel. Use a wrench to support the swivel while tightening the lead-in line.
7. Connect the female end of the lead-in line to the water supply. Use the included 1/2" adapter, if necessary.
8. Turn water supply on, Flush system and check for leaks.

Note: DO NOT use a rigid pipe at the input connection of the reel. Doing so will VOID the product warranty.

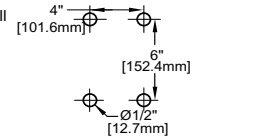

Figure 5, Mounting Hole Pattern

Operator Instructions

It is recommended that all personnel are properly trained on the operation of the hose reel BEFORE use.

1. Turn hose reel water supply "on".
2. Slowly pull out the hose to the desired length. While pulling out the hose, you will hear a set of 4 "clicking" sounds every half revolution. This is normal.
3. Watch for the red band marking the end of the hose. The red band marks the last set of clicks" before the hose is fully extended.

CAUTION To avoid hose reel lockout, DO NOT over-extend the hose beyond the red band marker.

3. To latch the hose reel at the desired hose length, pull the hose until you hear the next set of clicking sounds. Allow the hose to retract after the first, second or third "click".
4. To unlatch the hose reel, slowly pull the hose until the clicking sound stops. Then allow the hose to retract. Do not let go of a retracting hose. The ball stop should rest against the roller guide once the hose is completely wound back into the reel.

WARNING DO NOT allow the hose to retract without restraining the recoil speed. NEVER let go of the hose when retracting.

5. Be sure to shut the water supply off at the shut off valves when not in use for an extended period of time.

WARNING Damage and hose failure may result if water pressure is allowed to remain in hose over extended period of time. Shut water supply off at the shut-off valves.

Cleaning and Maintenance Instructions

To keep your Fisher Reel Rinse Unit in good working condition, periodic maintenance may be required.

FOR CLOSED REEL RINSE UNITS

1. Extend the hose from the reel rinse so that there is sufficient room to clean the inside of the unit. For safety reasons, it may be best to have one person extend and hold the hose while another cleans the inside of the unit.
2. To remove debris that may be trapped inside closed reel rinse units, remove the sleeve from the reel rinse by unscrewing the sleeve nuts from the mounting base.
3. With the hose extended and the sleeve removed, clean the roller guides thoroughly and remove any remaining debris from the inside of the unit.
4. Reattach the sleeve by installing it to its original position and screwing the sleeve nuts to the mounting base.
5. To clean the hose, wipe it down as it is allowed to gently retract back into the reel rinse unit. Allowing it to retract as you are cleaning it will prevent the hose from becoming dirty immediately after it has been cleaned.
6. Clean the spray valve and outside of the unit as necessary to preserve a clean working environment.

FOR OPEN REEL RINSE UNITS

1. Extend the hose from the reel rinse so that there is sufficient room to clean the inside of the unit. For safety reasons, it may be best to have one person extend and hold the hose while another cleans the inside of the unit.
2. With the hose extended, clean the roller guides thoroughly and remove any remaining debris from the inside of the unit.
3. To clean the hose, wipe it down as it is allowed to gently retract back into the reel rinse unit. Allowing it to retract as you are cleaning it will prevent the hose from becoming dirty immediately after it has been cleaned.
4. Clean the spray valve and outside of the unit as necessary to preserve a clean working environment.