

SYMMETRIX®

S-250 Series

Two Handle Lavatory Faucet

Symmetrix Two Handle 4" Cast Brass Centerset Lavatory Faucet with quarter turn ceramic control components and blade handles with red/blue indicators. 2.2 gpm (8.3 L/min) flow rate, 1/2" IPS shanks, solid brass construction, polished chrome finish.

- ☐ **S-250-2:** With lift rod and pop-up drain assembly
- ☐ **S-250-1:** With lift rod only
- ☐ **S-250-0:** Faucet only (no lift-rod hole)
- ☐ **S-250:** Faucet only

Options: Append suffix to model number

- ☐ **Suffix G:** Grid strainer drain assembly
- ☐ **Suffix VP:** Vandal resistant aerator
- ☐ **Suffix FR:** .5gpm (1.9 L/min) flow rate restrictor (vandal resistant)
- ☐ **Suffix 1.5:** 1.5gpm (5.7 L/min) flow rate restrictor
- ☐ **Suffix CR:** Metal cross handles
- ☐ **Suffix LCF:** Clear faceted insert handles
- ☐ **Suffix LCT:** Clear acrylic handles
- ☐ **Suffix LPO:** White insert handles
- ☐ **Suffix LWG:** Wrist blade handle

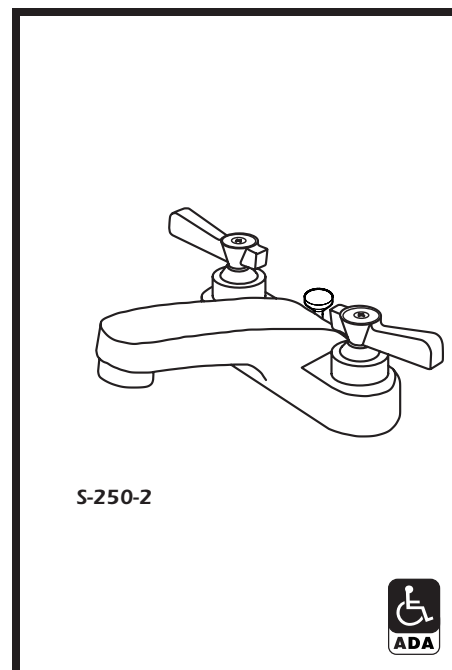

**SYMMONS PRODUCTS MEET
ANSI A112.18.1M, EPA '92
AND ALL KNOWN FLOW RATE
REQUIREMENTS.
Kitchen and Lavatory Faucets
2.2 GPM (8.3 L/min)**

Job/Location

.....
.....

Engineer

.....
.....

Contractor

.....
.....

Dimensions *Symmetrix Lavatory Faucet, S-250 Series*

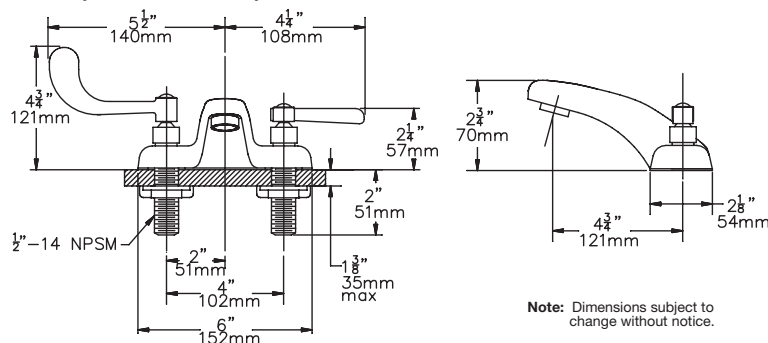

For ADA compliance (Americans with Disabilities Act) consult ADAAG or your state regulations for proper product choice and mounting locations.

Symmons Industries, Inc. ■ 31 Brooks Drive ■ Braintree, MA 02184
(800) 796-6667, (781) 848-2250 ■ Fax (800) 961-9621, (781) 843-3849
Website: www.symmons.com ■ Email: customerservice@symmons.com

©2003, 2008 Symmons Industries, Inc. Printed in U.S.A. ■ 050108

SYMMONS®
the smart choice™