



Lavatory Faucet SLS-3512, SLS-3510 Series

Installation Brief



Model SLS-3512

Model Numbers

SLS-3512	Lavatory faucet with lift rod and pop-up drain, p/n LN-01295
SLS-3510	Lavatory faucet only, p/n LN-01296

Decorative Finishes

Append finish suffix code to replacement part numbers when applicable

- Polished chrome (standard)

Tools & Materials

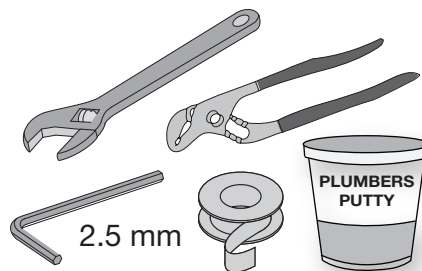

Need Help?

Contact Symmons customer service at
P: (800) 796-6667, F: (800) 961-9621
Email: customerservice@symmons.com
Monday - Friday 7:30 am - 7:00 pm EST

Please check Symmons website for technical help, the latest product information and warranty policy.
www.symmons.com/service

For California Residents

WARNING: This product contains chemicals known to the State of California to cause cancer, birth defects, or other reproductive harm.

Quick Install Guide Dia Lavatory Faucet, SLS-3512, SLS-3510 Series

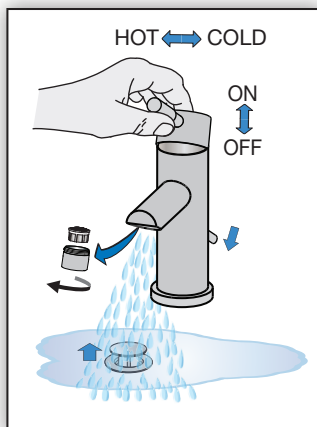

Step 3
Flush lines and check for leaks

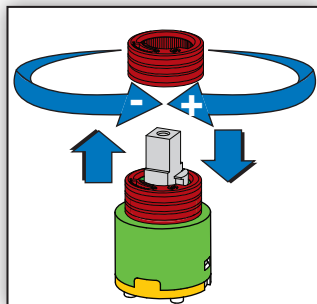

Optional
Adjust limit stop washer to limit handle turn to the hot position if desirable

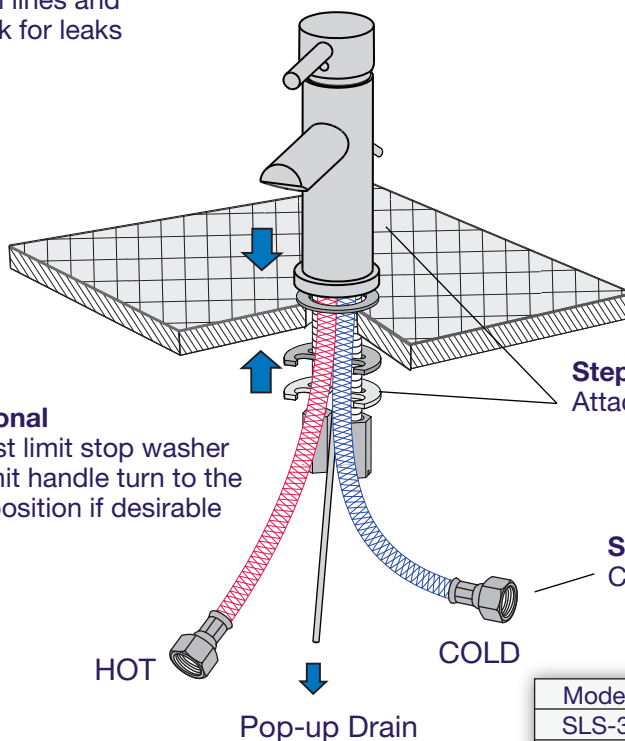

Step 1
Attach faucet assembly

Step 2
Connect supply hoses

Model	Part No.
SLS-3512	LN-01295
SLS-3510	LN-01296

Dimensions Dia Lavatory Faucet, SLS-3512, SLS-3510 Series

Model	Part No.
SLS-3512	LN-01295
SLS-3510	LN-01296

Note:

- (1) Dimensions subject to change without notice
 (2) Lift rod included with model SLS-3512-1.5 only
-

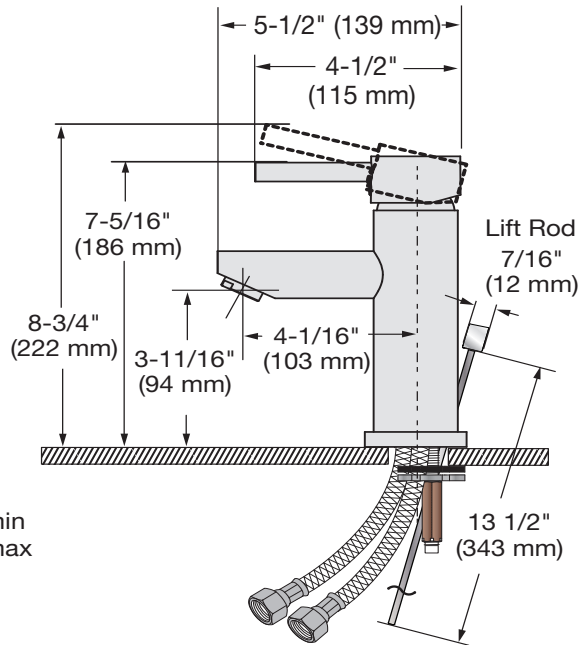



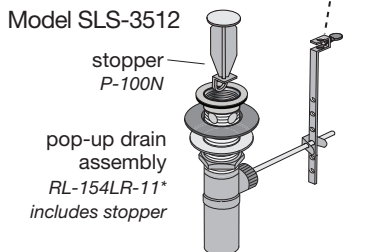
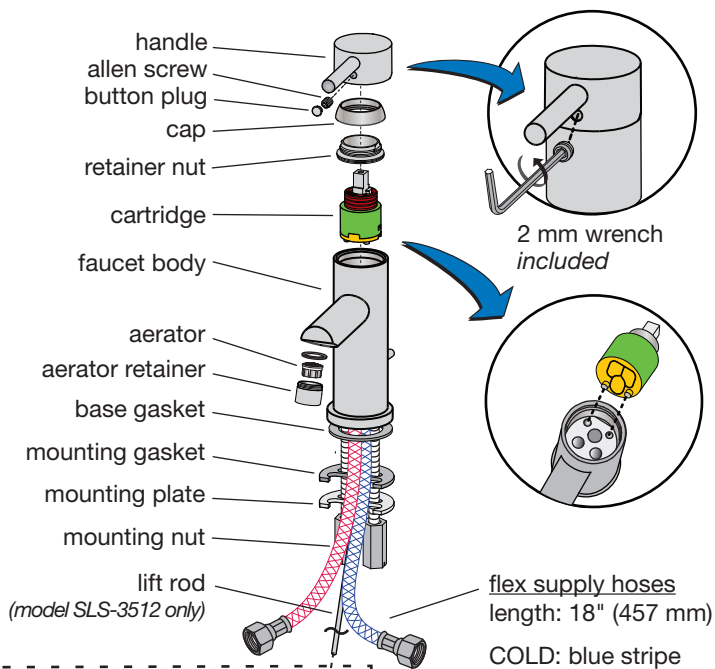

Parts Assembly Dia Lavatory Faucet, SLS-3512, SLS-3510 Series



Model	Part No.
SLS-3512	LN-01295
SLS-3510	LN-01296

Replacement Parts

Part Number	Item
RL-279	Cartridge with limit stop 
LN-15*	<u>Aerator kits</u> 
FLR-110-1.5*	2.2 gpm (8.3 L/min)
FLR-110-1.0*	1.5 gpm (5.7 L/min)
RL-071*	1.0 gpm (3.8 L/min)
	0.5 gpm (1.9 L/min)
	includes aerator, retainer & washer
LN-01386*	<u>Handle kit</u>  includes handle, allen screw & RB button plug requires 2 mm Allen wrench
RL-238	<u>Mounting hardware kit</u>  threaded studs (2) hex nut (2) rubber washer (1) metal washer (1)
LN-341*	Lift Rod 

Ordering replacement parts:

Call Symmons customer service at (800) 796-6667, M-F 7:30 am - 7:00 pm EST or check our website at www.symmons.com for a list of Symmons distributors.

* Note: For decorative finish faucets append the appropriate suffix code letters to part numbers marked with an asterisk (*)