



T&S BRASS AND BRONZE WORKS, INC.

2 Saddleback Cove / P.O. Box 1088
Travelers Rest, SC 29690



REG. #A2601
ISO #9001

Model No.

B-0892-CR

Item No.

Travelers Rest, SC: 800-476-4103 Simi Valley, CA: 800-423-0150 Fax: 864-834-3518 www.tsbrass.com

This Space for Architect/Engineer Approval

Job Name _____ Date _____

Model Specified _____ Quantity _____

Customer/Wholesaler _____

Contractor _____

Architect/Engineer _____



ADA Compliant

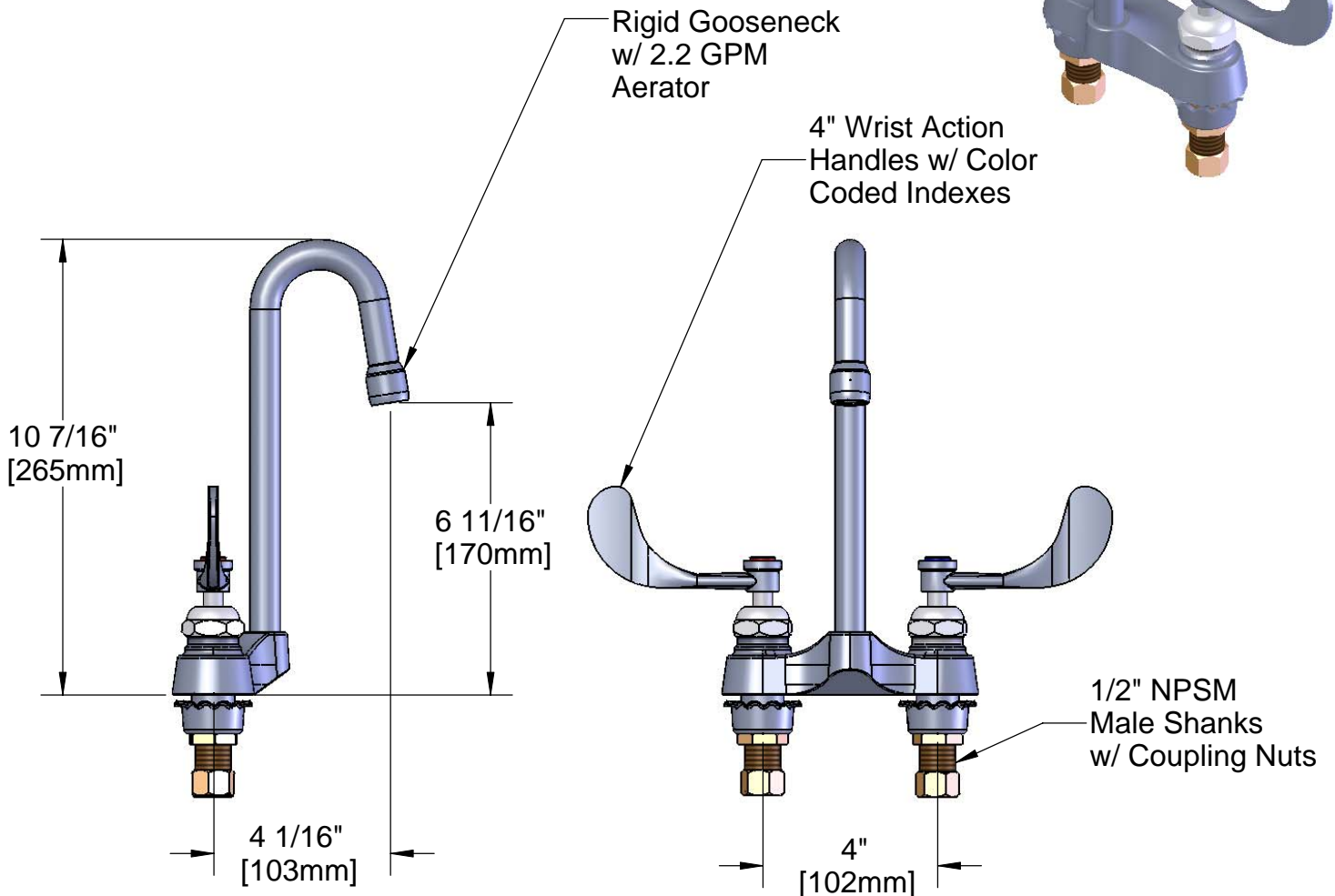
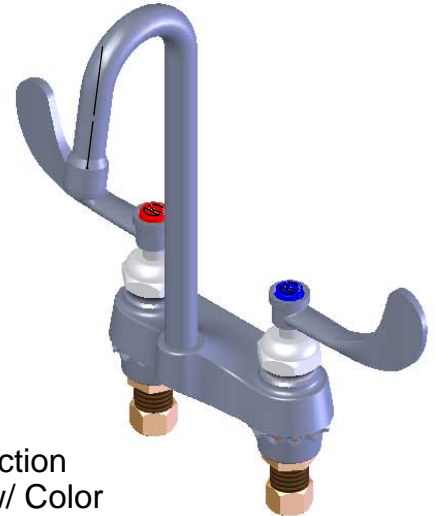

Product Specifications:
 4" Centerset Mixing Faucet, 1/2" NPSM Male Shanks,
 Ceramic Cartridges, 4" Wrist Action Handles,
 Rigid Gooseneck w/ 2.2 GPM Aerator

Drawn DHL	Checked JRM	Approved JHB
Scale: 1:4		Date: 07/21/08



T&S BRASS AND BRONZE WORKS, INC.

2 Saddleback Cove / P.O. Box 1088
Travelers Rest, SC 29690



REG. #A2601
ISO #9001

Model No.

B-0892-CR

Item No.

Travelers Rest, SC: 800-476-4103 Simi Valley, CA: 800-423-0150 Fax: 864-834-3518 www.tsbrass.com

ITEM NO.	SALES NO.	DESCRIPTION
1	005028-40	Gooseneck
2	B-0199-01	2.2 GPM Aerator, 55/64-27 Female
3	001194-45	Red HW Index
4	011278-25	Ceramic Cartridge RTC
5	001686-45	Blue CW Index
6	000925-45	Lab Handle Screw
7	B-WH4	4" Wrist Action Handle
8	011279-25	Ceramic Cartridge LTC
9	001000-45	Rosette Washer
10	002954-45	Shank Lock Nut
11	000958-20	Coupling Nut

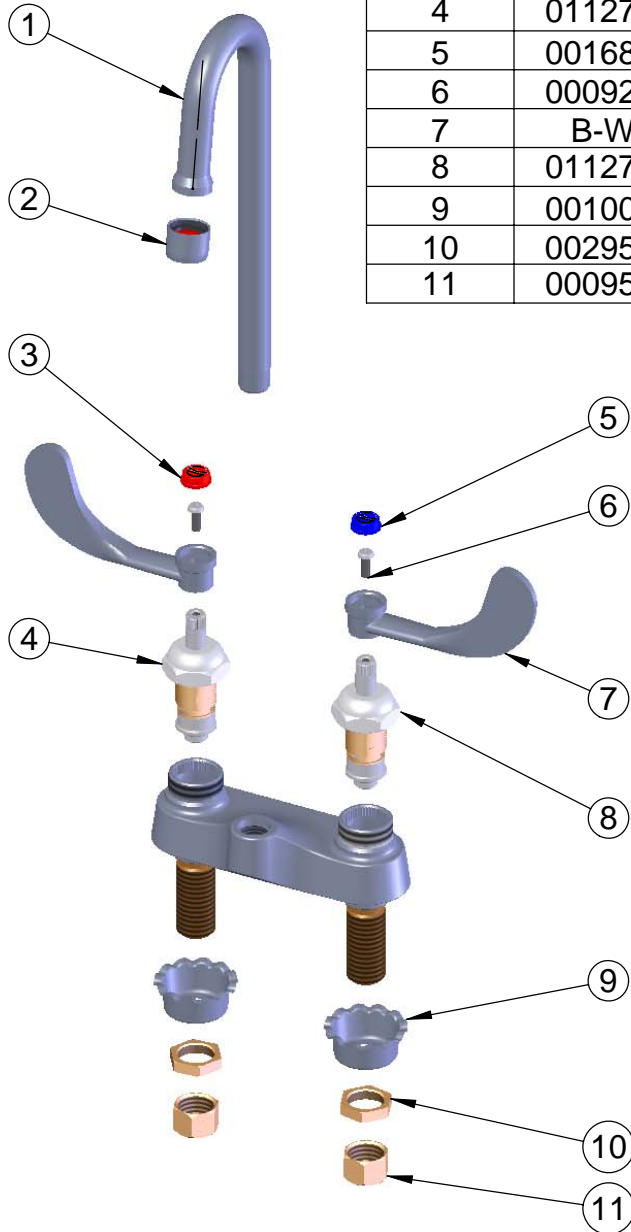

Product Specifications:

4" Centerset Mixing Faucet, 1/2" NPSM Male Shanks,
Ceramic Cartridges, 4" Wrist Action Handles,
Rigid Gooseneck w/ 2.2 GPM Aerator

Drawn DHL	Checked JRM	Approved JHB
Scale: 1:4		Date: 07/21/08