



T&S BRASS AND BRONZE WORKS, INC.

2 Saddleback Cove / P.O. Box 1088
Travelers Rest, SC 29690



REG. #A2601
ISO #9001

Model No.

B-3945-BSP

Item No.

Travelers Rest, SC: 800-476-4103 Simi Valley, CA: 800-423-0150 Fax: 864-834-3518 www.tsbrass.com

This Space for Architect/Engineer Approval

Job Name _____ Date _____

Model Specified _____ Quantity _____

Customer/Wholesaler _____

Contractor _____

Architect/Engineer _____

Waste Drain Sold Separately
(Shown only for Reference)

2" NPT Male Drain Outlet

2" NPT Female x 1 1/2-11 BSP
(G 1-1/2 B) Male Adapter

2" NPT Female

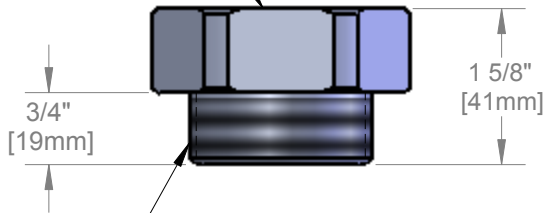

1 1/2-11 BSP
(G 1-1/2 B) Male

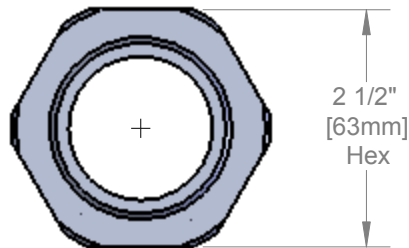

Product Specifications:

Rotary Waste Valve Adapter
2" NPT Female x 1 1/2-11 BSP
(G 1-1/2 B) Male Thread

Drawn
DHL

Checked
GEF

Approved
JHB

Scale:

1:2

Date:

8/14/06